

ASSEMBLY INSTRUCTIONS

BMX FORMULA 3™ POWER CYCLE®

Ages 3 to 8
Weight Limit 70 lbs.

PLEASE NOTE: ADULT ASSEMBLY REQUIRED. READ INSTRUCTIONS PRIOR TO ASSEMBLY.

TOOLS REQUIRED (NOT INCLUDED): Hammer, Phillips Screwdriver and a small block of wood (approx. 2" x 2" x 3/4").

WARNING:

ADULT SUPERVISION AND INSTRUCTION REQUIRED REGARDING THE PROPER USE OF THIS TOY. THIS RIDE-ON TOY SHOULD NOT BE USED NEAR SWIMMING POOLS, ON OR NEAR HILLS, ROADWAYS, SLOPED DRIVEWAYS, ALLEYS OR STEPS. SHOES MUST BE WORN AT ALL TIMES. ONLY ONE RIDER AT A TIME. DO NOT RIDE AFTER DARK. DO NOT CARRY ANYTHING THAT IMPAIRS VISION.

STEP 1. FRONT WHEEL PEDAL ASSEMBLY

Slide a pedal onto the crankshaft in the position shown. Then, fit a palnut over the protruding end of the crankshaft as shown.

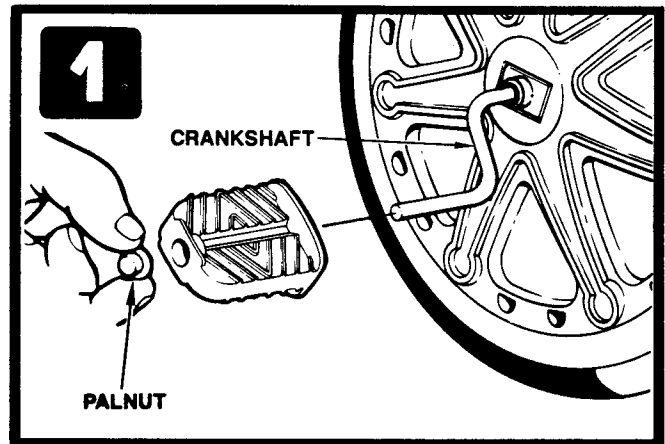

STEP 2. SECURE PEDALS TO PEDAL CRANKSHAFT

Use the edge of a flat surface to support the wheel pedal assembly. Then, position the palnut tool over the palnut and strike the end of the tool with the hammer. Make sure the palnut is engaged by pulling on the pedal. Repeat STEPS 1 and 2 for the opposite side of the front wheel.

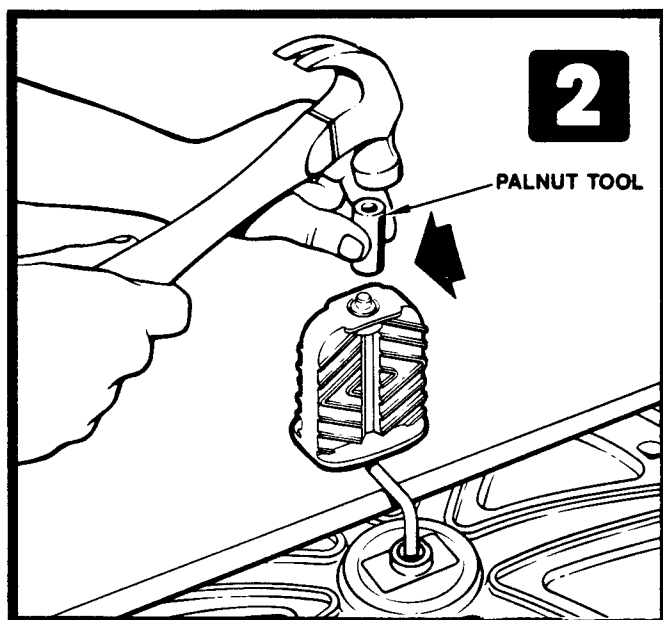

STEP 3. FORK AND WHEEL ASSEMBLY

Install the assembled front wheel into the fork by positioning the crankshaft into the slots in the fork as shown.

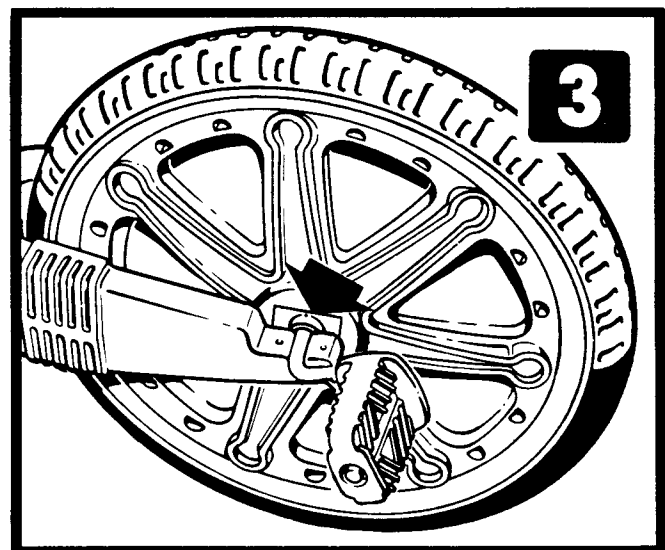

STEP 4. SECURE FRONT WHEEL TO FORK

Position an axle cap over the pedal crank. Next, using the screwdriver, tap and drive a 1" length screw into the hole closest to the top of the fork. Do the same with a 5/8" length screw in the remaining hole. Repeat this step for the other side of the fork.

NOTE: Do not use excessive force when driving the screw into the front fork. Do not overtighten.

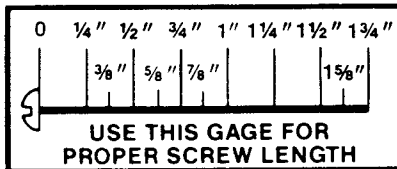
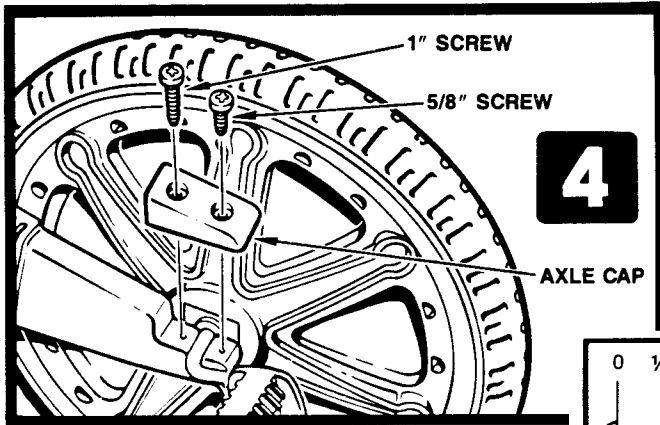

STEP 6. SECURE REAR WHEELS TO BODY ASSEMBLY

Put a palnut on the end of the rear axle. Using the palnut tool and hammer, fasten the palnut as shown. This will fasten the wheels to the body assembly. Make sure block of wood is placed as shown.

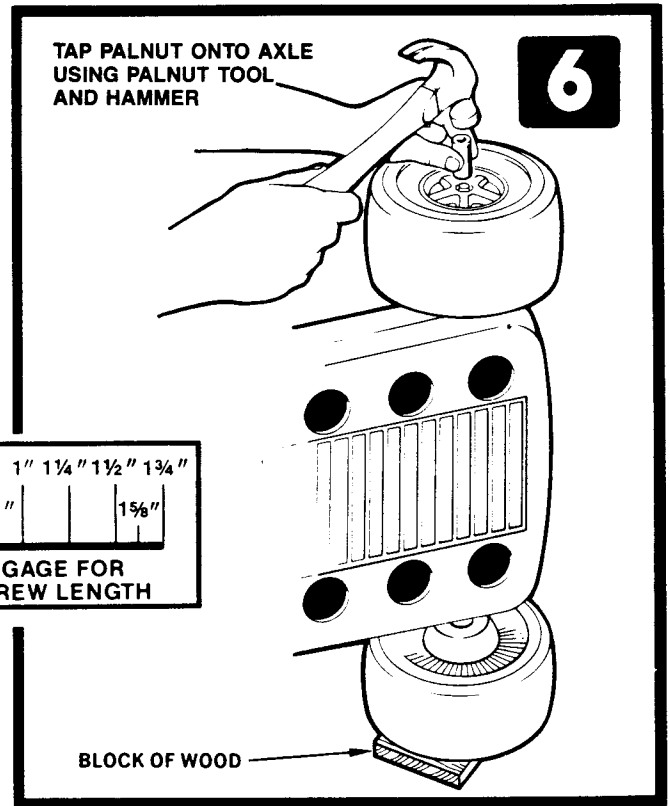

STEP 5. ASSEMBLE REAR WHEELS TO BODY

Place the rear axle onto a small block of wood, as shown. Secure a palnut to one end of axle using the palnut tool. With the 5 spokes facing out, slide axle through one wheel and then through left side of body. Then, slide the clicker onto the axle and into body recess to the position shown.

Put the other rear wheel (with 5 spokes out) onto the rear axle.

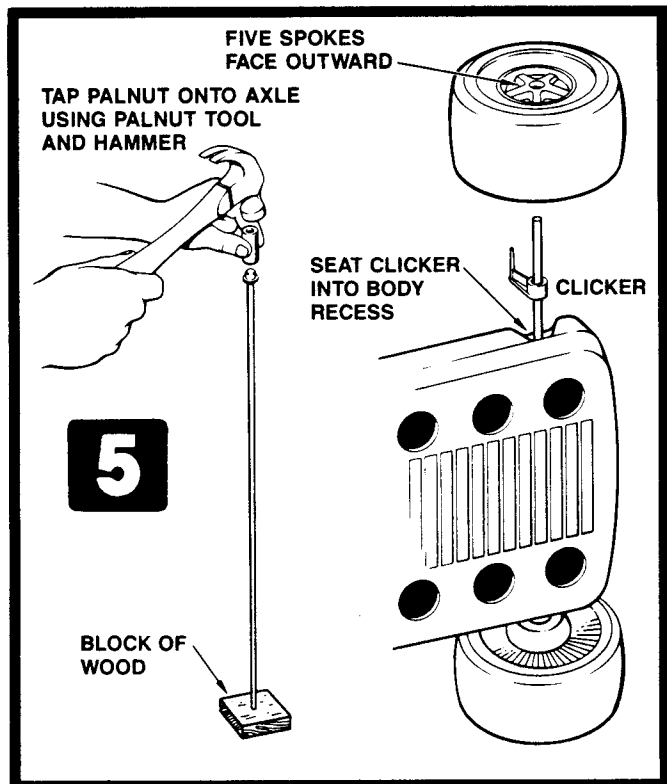

STEP 7. ATTACH FRONT FORK AND HANDLEBAR

Insert the front fork through body. The axle caps must face the back of the cycle. Then, slide the handlebar onto the fork post, handles facing back. Handlebar must be fully seated to fork.

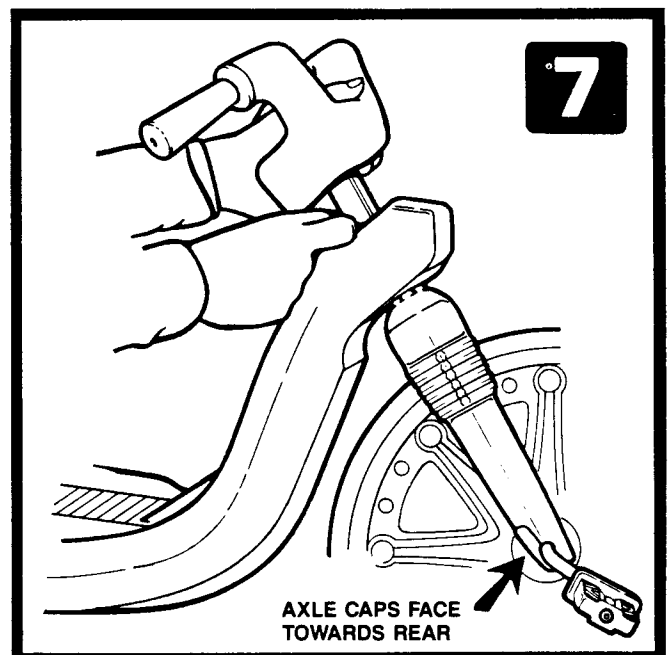

STEP 8. FASTEN HANDLEBAR

Insert two (2) 1 3/4" screws into pilot holes on each side of the handlebar until screws are engaged. Then turn cycle upside down on its handlebars. Push down on fork and screw the screws tightly into handlebar assembly.

BE CAREFUL NOT TO OVERTIGHTEN.

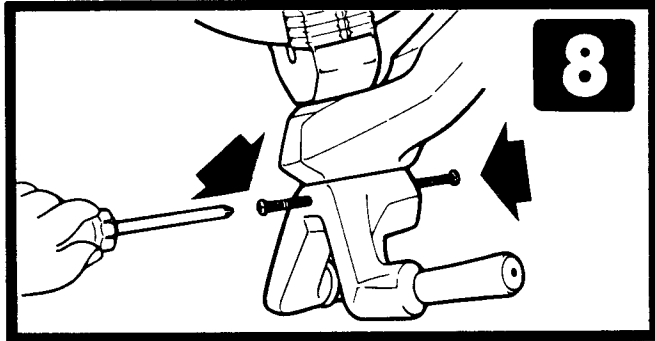

STEP 10. DECAL INSTRUCTIONS

NOTE: Thoroughly wipe decal areas with clean, dry cloth before applying decals.

Using decal sheet, remove decals one at a time and apply to appropriate positions on Power Cycle as shown on diagram.

BESAFE

- DO NOT RIDE POWER CYCLE AFTER DARK.
- DO NOT CARRY ANYTHING THAT WILL IMPAIR VISION.
- DO NOT RIDE DOUBLE ON YOUR POWER CYCLE.

IMPORTANT NOTICE

PARENTS: PLEASE MAKE PERIODIC INSPECTIONS OF ALL POWER CYCLE HARDWARE TO ENSURE THAT IT IS SECURE.

STEP 9. INSTALL SEAT BACK

Push the seat posts into the desired set of holes to accommodate the driver.

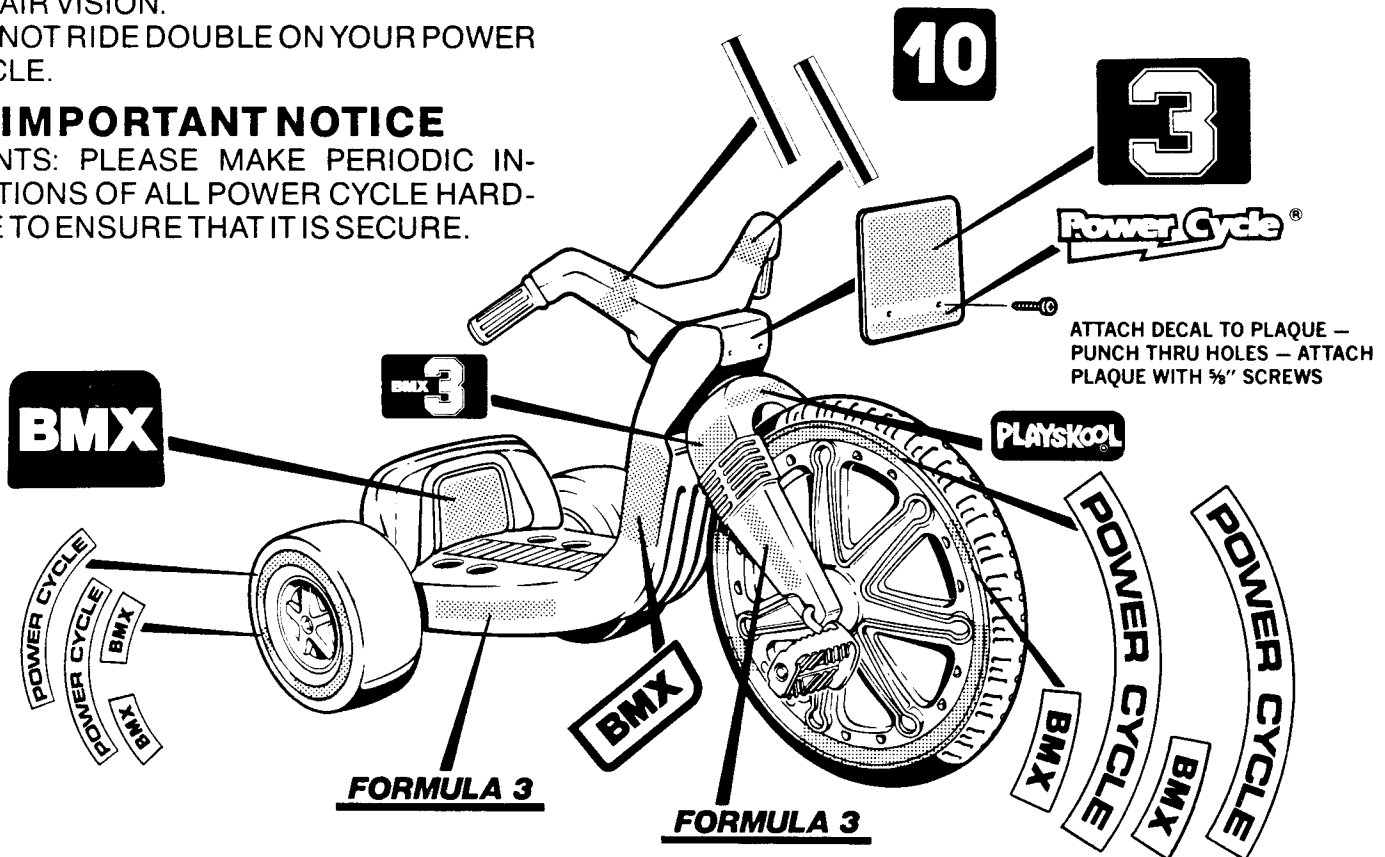
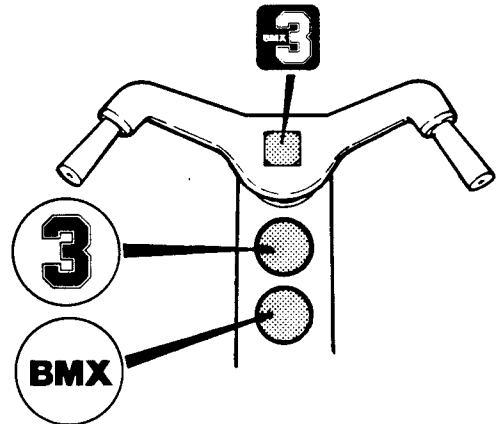
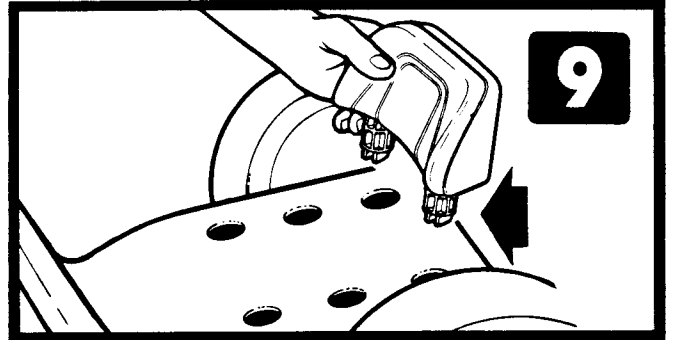

IMPORTANT
 DECALS HAVE QUICK SETTING ADHESIVE, BE SURE OF POSITION BEFORE APPLYING—DECAL CANNOT BE LIFTED AFTER SETTING.

PLEASE RETAIN THIS GUIDE AND ALL LITERATURE FOR FUTURE REFERENCE

BMX FORMULA 3™ POWER CYCLE® NO. 1833

Replacement Parts Order Form

KEY NO.

- 1. BODY (1)
- 2. REAR WHEELS (2)
- 3. SEAT BACK (1)
- 4. HANDLEBAR (1)
- 5. FRONT FORK (1)
- 6. FRONT WHEEL W/PEDAL CRANK (1)
- 7. PEDALS (2)
- 8. AXLE CAPS (2)
- 9. REAR AXLE (1)
- 10. PLAQUE (1)

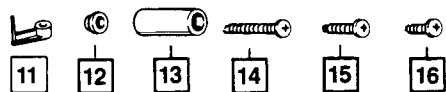

- 11. CLICKER (1)
- 12. PALNUTS (4)
- 13. PALNUT TOOL (1)
- 14. 1 3/4" SCREWS (2)
- 15. 1" SCREWS (2)
- 16. 5/8" SCREWS (4)
- 17. DECAL SHEETS (1) — not shown

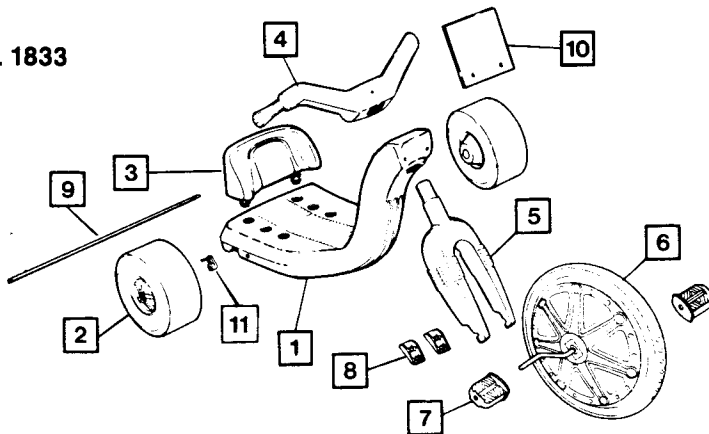

REPLACEMENT PARTS LISTED BELOW ARE THE ONLY ONES AVAILABLE

KEY NUMBER	DESCRIPTION	KIT NO.	QUANTITY	PRICE	TOTAL
1	BODY: (Not available as a replacement part).	—	—	—	—
2	REAR WHEEL: (1 each).	40282900		\$1.80	
3	SEAT BACK: (1 each).	40282600		1.00	
4	HANDLEBAR: (1 each).	40282500		1.80	
5	FRONT FORK: (1 each).	40282700		2.20	
6	FRONT WHEEL WITH CRANK: Includes Front Wheel with Crank (1 ea)	40284700		9.25	
8	AXLE CAP KIT: (Universal Replacement)	1006		1.00	
10, 17	DECORATIVE KIT: Includes Decal Sheet (1 ea); Plaque (1 ea).	KIT 397		3.10	
7, 12	PEDAL KIT: Includes Pedal (2 ea); Palnut (2 ea).	KIT 1001		1.50	
9	REAR AXLE: (1 each).	40282800		1.00	
14, 15, 16	HARDWARE KIT: Includes correct amount of each key number listed.	KIT 431		1.80	
11, 12, 13	PALNUT BAG: Includes correct amount of each key number listed.	KIT 381A		1.50	

HOW TO ORDER PARTS

1. Fill out shipping label below. Print clearly, in ink, as label will be applied to the outside of your package. U.S. residents be sure to include ZIP code.
2. Extend prices, NY, PA, RI residents add applicable sales tax, plus shipping and handling.
3. Send complete form with check or money order only (DO NOT MAIL CASH OR COINS) to address below.
4. No C.O.D. orders will be accepted.
5. We reserve the right to substitute when necessary.

Submit mail order to: Playskool, Inc., P.O. Box 5839, Pawtucket, RI 02862

NOTE: Prices and parts subject to change without prior notice.

MERCHANDISE TOTAL	
APPROPRIATE STATE TAX	
HANDLING AND SHIPPING	
TOTAL	

HANDLING AND SHIPPING RATES BASED ON DOLLAR TOTAL OF ORDER	
ORDER TOTAL	HANDLING & SHIPPING
\$ 0.00 - \$ 10.00	\$3.50
\$10.01 - \$ 50.00	\$4.00
\$50.01 - \$150.00	10% of total order

Model No. 50540

BMX FORMULA 3™ POWER CYCLE®

FOR OFFICE USE ONLY

DATE REC'D _____
 AM'T REC'D _____
 REC'D BY _____
 DATE SHIPPED _____
 VIA _____
 NOTES _____

TO:

NAME _____
 STREET _____
 CITY _____ STATE _____
 ZIP CODE _____ COUNTY _____

POSTMASTER: CONTENTS MERCHANDISE — RETURN POSTAGE GUARANTEED.
 MAY BE OPENED FOR POSTAL INSPECTION IF NECESSARY.