



Electronic

AGE 8+
82615 & 82616/82529 Asst.

HIGH PERFORMANCE TOPS

B-5

Electronic Dragoon Storm2™

⚠ WARNING: Do not use BEYBLADE tops or Beystadium™ on tables or other elevated surfaces.

BEYBLADE tops/BEYSTADIUM are intended to be used on the floor. Do not lean over the stadium when BEYBLADE tops are in play. BEYBLADE tops may bounce up and hit eye or face.

Includes 4 x 1.5 v A76/LR44 button cell batteries.
Phillips/crosshead screwdriver needed (not included)
to replace batteries. See instructions.

Includes BEYBLADE top, launcher, ripcord and bit chip.

BEYSTADIUM™ not included.

NOTE:

This top comes with a Bit Chip that can be used with BEYBLADE ELECTRONIC LAUNCHERS (sold separately).

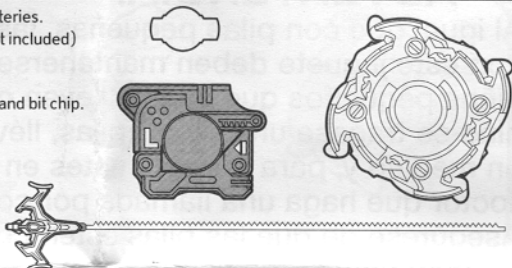

LAUNCH:

1 Peel and apply sticker to smooth side of bit chip.

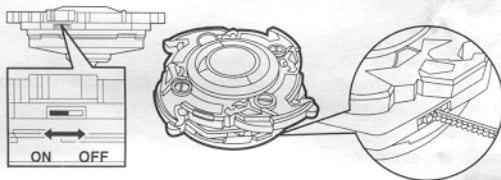

Move ON/OFF switch to ON position.
(Use tip of ripcord to move switch.)

2

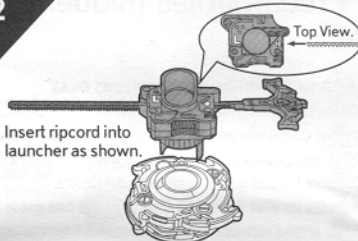

Insert ripcord into launcher as shown.

NOTE: Use left-spin launchers for Left Spin Gears; use right-spin launchers for Right Spin Gears.

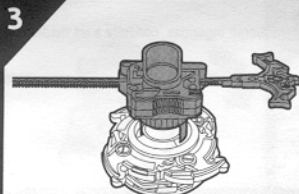

Insert posts on launcher into openings in BEYBLADE top, as shown. Launcher should stay attached to BEYBLADE top when inserted correctly.

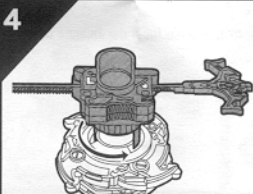

Hold lower half of launcher and rotate BEYBLADE top left to lock it in place.

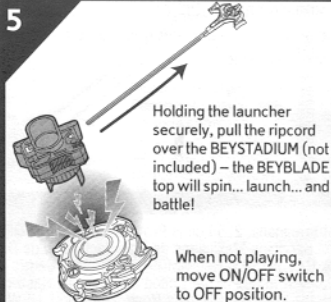

Holding the launcher securely, pull the ripcord over the BEYSTADIUM (not included) – the BEYBLADE top will spin... launch... and battle!

When not playing, move ON/OFF switch to OFF position.

TO REPLACE BATTERIES

Using a Phillips/crosshead screwdriver, remove the 2 screws from underside of top. Remove base cover. Remove and discard batteries. Insert 4 fresh A-76/LR44 button cell batteries as shown. Alkaline batteries recommended. Replace base cover, and re-attach screws tightly with screwdriver.

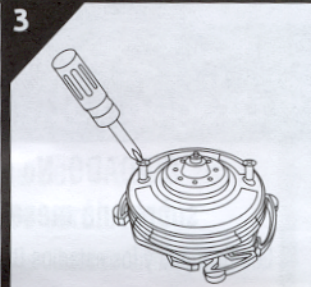
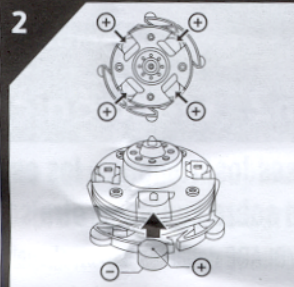
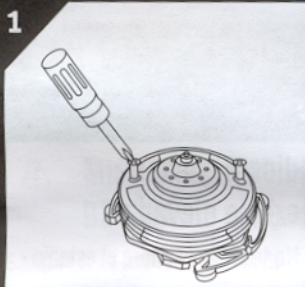

⚠ CAUTION

1. As with all small batteries, the batteries used with this toy should be kept away from small children who still put things in their mouths. If they are swallowed, promptly see a doctor and have the doctor phone (202) 625-3333 collect, or in Canada, have the doctor call your provincial Poison Control Center.
2. Make sure the batteries are inserted correctly and follow the toy and battery manufacturers' instructions.
3. Do not mix old and new batteries, alkaline, standard (carbon-zinc) or rechargeable (nickel-cadmium) batteries.

IMPORTANT: BATTERY INFORMATION

Please retain this information for future reference. Batteries should be replaced by an adult.

CAUTION:

1) Always follow the instructions carefully. Use only batteries specified and be sure to insert them correctly by matching the + and - polarity markings. 2) Do not mix old batteries and new batteries, or standard (carbon-zinc) with alkaline batteries. 3) Remove exhausted or dead batteries from the product. 4) Remove batteries if product is not to be played with for a long time. 5) Do not short-circuit the supply terminals. 6) Should this product cause, or be affected by, local electrical interference, move it away from the other electrical equipment. Reset (switching off and back on again or removing and re-inserting batteries) if necessary. 7) RECHARGEABLE BATTERIES: Do not mix these with any other types of battery. Always remove from the product before recharging. Recharge batteries under adult supervision. DO NOT RECHARGE OTHER TYPES OF BATTERIES. 8) As with all small items, these batteries should be kept away from children. If swallowed, seek medical attention immediately.

FCC Statement:

This equipment has been tested and found to comply with the limits for a Class B digital device, pursuant to part 15 of the FCC Rules. These limits are designed to provide reasonable protection against harmful interference in a residential installation. This equipment generates, uses and can radiate radio frequency energy, and, if not installed and used in accordance with the instructions, may cause harmful interference to radio communications. However, there is no guarantee that interference will not occur in a particular installation. If this equipment does cause harmful interference to radio or television reception, which can be determined by turning the equipment off and on, the user is encouraged to try to correct the interference by one or more of the following measures:

- Reorient or relocate the receiving antenna.
- Increase the separation between the equipment and receiver.
- Consult the dealer or an experienced radio/TV technician for help.

