

BEYBLADE

HIGH PERFORMANCE TOPS

AGES 8+

82529 Asst.

Let it Rip!

B-9

Electronic Dragon Phantom™

⚠ WARNING: Do not use BEYBLADE tops or Beystadium™ on tables or other elevated surfaces.

BEYBLADE tops/BEYSTADIUM are intended to be used on the floor. Do not lean over the stadium when BEYBLADE tops are in play. BEYBLADE tops may bounce up and hit eye or face.

Includes BEYBLADE top, launcher, ripcord, Bit Chip and instructions.

Includes 4 A-76 button cell batteries. Phillips screwdriver (not included) needed to replace batteries.

BIT CHIP

This top comes with a Bit Chip that can be used with BEYBLADE ELECTRONIC LAUNCHERS (sold separately).

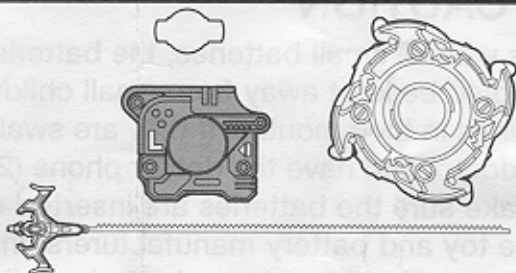

LAUNCH:

1

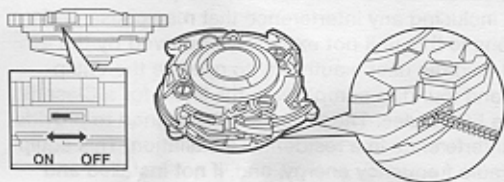

Move ON/OFF switch to ON position.
(Use tip of ripcord to move switch.)

2

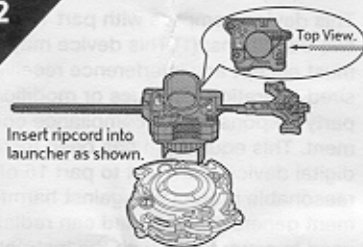

Insert ripcord into launcher as shown.

NOTE: Use left-spin launchers for Left Spin Gears; use right-spin launchers for Right Spin Gears.

3

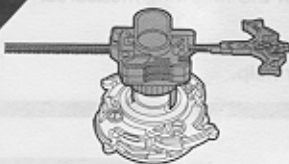

Insert posts on launcher into openings in BEYBLADE top, as shown. Launcher should stay attached to BEYBLADE top when inserted correctly.

4

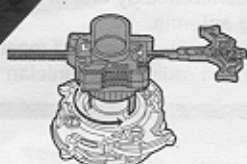

Hold lower half of launcher and rotate BEYBLADE top left to lock it in place.

5



Holding the launcher securely, pull the ripcord over the BEYSTADIUM (not included) - the BEYBLADE top will spin... launch... and battle!

When not playing, move ON/OFF switch to OFF position.

TO REPLACE BATTERIES

Using a Phillips screwdriver, remove the 2 screws from underside of top. Remove base cover. Insert 4 fresh A-76 button cell batteries as shown. Replace base cover, and re-attach screws tightly.

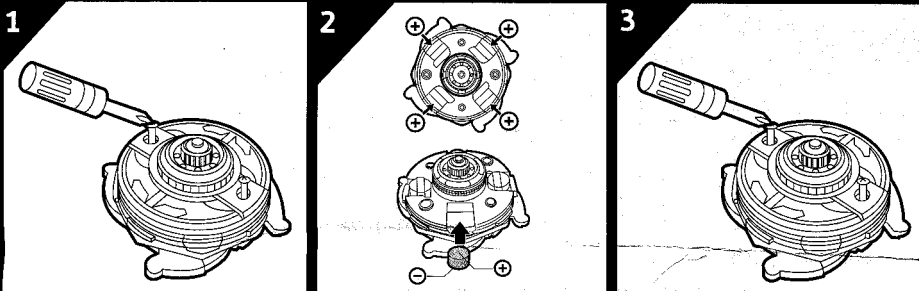

! CAUTION

- 1) As with all small batteries, the batteries used with this toy should be kept away from small children who still put things in their mouths. If they are swallowed, promptly see a doctor and have the doctor phone (202) 625-3333 collect.
- 2) Make sure the batteries are inserted correctly and follow the toy and battery manufacturers' instructions.
- 3) Do not mix old and new batteries, alkaline, standard (carbon-zinc) or rechargeable (nickel-cadmium) batteries.

FCC Statement:

This device complies with part 15 of the FCC Rules. Operation is subject to the following two conditions: (1) This device may not cause harmful interference, and (2) this device must accept any interference received, including any interference that may cause undesired operation. Changes or modifications to this unit not expressly approved by the party responsible for compliance could void the user's authority to operate the equipment. This equipment has been tested and found to comply with the limits for a Class B digital device, pursuant to part 15 of the FCC Rules. These limits are designed to provide reasonable protection against harmful interference in a residential installation. This equipment generates, uses and can radiate radio frequency energy, and, if not installed and used in accordance with the instructions, may cause harmful interference to radio communications. However, there is no guarantee that interference will not occur in a particular installation. If this equipment does cause harmful interference to radio or television reception, which can be determined by turning the equipment off and on, the user is encouraged to try to correct the interference by one or more of the following measures:

- Reorient or relocate the receiving antenna.
- Increase the separation between the equipment and receiver.
- Consult the dealer or an experienced radio/TV technician for help.



Product and colors may vary.
® and/or TM & © 2002 Hasbro. All Rights Reserved.
© denotes Reg. U.S. Pat. & TM Office.
Manufactured under license from Takara Co., Ltd.
©HUDSON SOFT/TAKARA-BEYBLADE PROJECT-TV TOKYO. All Rights Reserved.



P/N 616660000