

Includes unassembled BEYBLADE top, launcher, and ripcord.
Assembly required. No tools needed.

⚠ WARNING: Do not use BEYBLADE tops or BEYSTADIUM[™] on tables or other elevated surfaces.

BEYBLADE tops/BEYSTADIUM are intended to be used on the floor. Do not lean over the stadium when BEYBLADE tops are in play. BEYBLADE tops may bounce up and hit eye or face.

- Before assembly and playing, please read instructions. Please keep these instructions for future reference.
- When removing parts from runner frame, ask an adult to help you trim off any excess plastic using scissors or other suitable tool.
- The frame is numbered. Please follow the numbers carefully and make sure you are assembling the right parts.
- Discard plastic bags immediately.

PARTS:

Runner Frame Parts, Attack Ring, Right Spin Engine Gear, Weight Disk, Blade Base

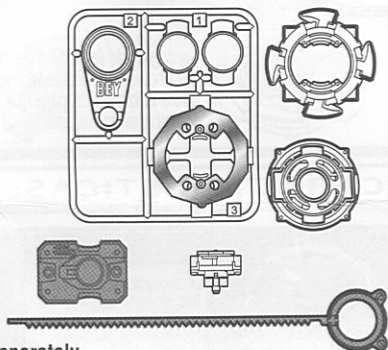

BEYSTADIUM sold separately.

BUILD:

1 Attach the stickers as shown in the diagram.

2 Push up the tabs on the outside of Lock Parts (2 places) and pull out.

* Opening the Lock Parts (2 places) will enable you to attach Right Spin Engine Gear.

3 Attach the Engine Gear to the Blade Base.

4 Push in and press down Lock Parts (2 places) to secure the Right Spin Engine Gear.

*Once the Lock Parts (2 places) are in place, Right Spin Engine Gear will not come out.

5 Place Weight Disk on Blade Base.

7 Place Attack Ring on Blade Base, aligning tabs on ring with grooves on Right Spin Engine Gear. Turn ring LEFT until it locks onto spin gear. To remove ring from gear, turn ring right.

8 Your BEYBLADE top is now ready for battle!

6 Attach Bit Chip to Attack Ring.

LEFT TO LOCK

LAUNCH:

- A** Attach the Turbo Winder to the Engine Gear shaft and wind clockwise (for Right Spin Gear tops) or counter-clockwise (for Left Spin Gear tops).

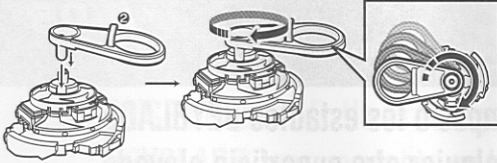

- B** Insert ripcord into launcher as shown.

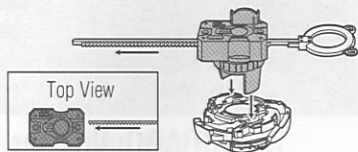

- C** Insert posts on launcher into openings in BEYBLADE top, as shown. Launcher should stay attached to BEYBLADE top when inserted correctly.

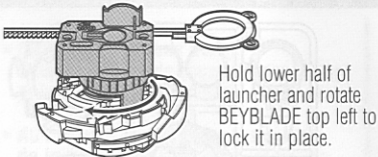

Hold lower half of launcher and rotate BEYBLADE top left to lock it in place.

- D** Holding the launcher securely, pull the ripcord over the BEYSTADIUM (not included) — the BEYBLADE top will spin... launch... and battle!

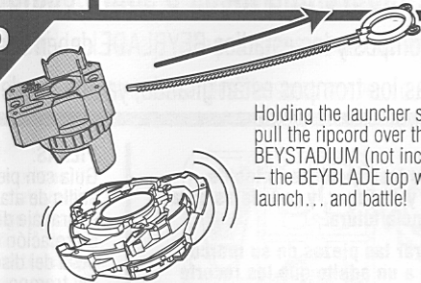

FEATURES:

ENGINE GEAR Type 1

Instant release: This type releases its spin energy upon launch. The spin comes in a powerful burst of speed.

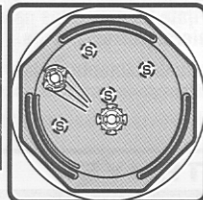
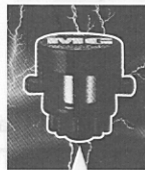
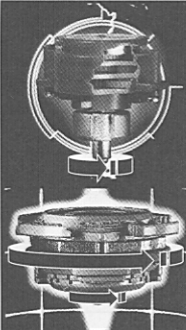

Greater acceleration with your Engine Gear: Engine Gear tops are equipped with an Engine Gear for a short-term power blast. When the engine kicks in, even a semi-flat tip will be transformed into a tip boosting super mobility. What is Engine Gear? It is a new battle part invented to improve the battle potential of your BEYBLADE. The rotational forces of the BEYBLADE and the engine combine to improve your BEYBLADE with super acceleration performance!

CUSTOMIZE FOR EACH BATTLE!

WHAT IS CUSTOMIZING?

Customizing is taking parts from different BEYBLADE tops and putting them together to create a new top. Why customize? Because you can change how your top will perform in battle. By switching parts, you can create a top that will perform a certain way. For example, if your opponent has an Attack Type top, you may want to change your top's parts to make it a Defense Type top, to help withstand your opponent's attacks.

Learn all the different types of Attack Rings, Weight Disks and Spin Gears that are available and that you have in your collection. Look at the star chart on the packages to see the strengths of each top's parts and check out the website beyblade.hasbro.com for more information!

TRIPLE SHOT You and your opponent each battle 3 BEYBLADE tops for triple the action!



Get your 3 BEYBLADE tops ready.



Decide the play order of your BEYBLADE tops.



To start the game, players launch their first BEYBLADE top.

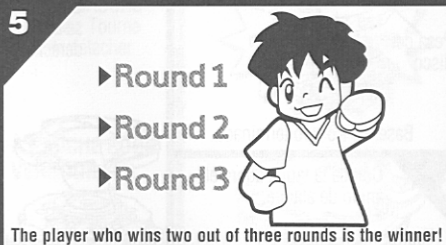
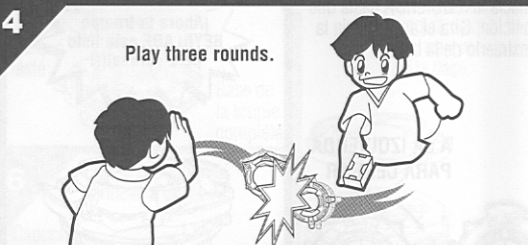

The player who wins two out of three rounds is the winner!



www.beyblade.com
beyblade.hasbro.com



Watch it on
abc family

Product and colors may vary.
©* and/or TM* & © 2004 Ha
© Aoki Takao/BB3Project-TV 1
TM & © ABC Family Worldwi