

AGES 3+
08121

PLAYSKOOL[®]

Charlie Coal the Grill™

Includes grill, 2 legs, mustard bottle, ketchup bottle, fork, spatula, 2 plastic burger buns, plastic burger, plastic hot dog bun and plastic hot dog.

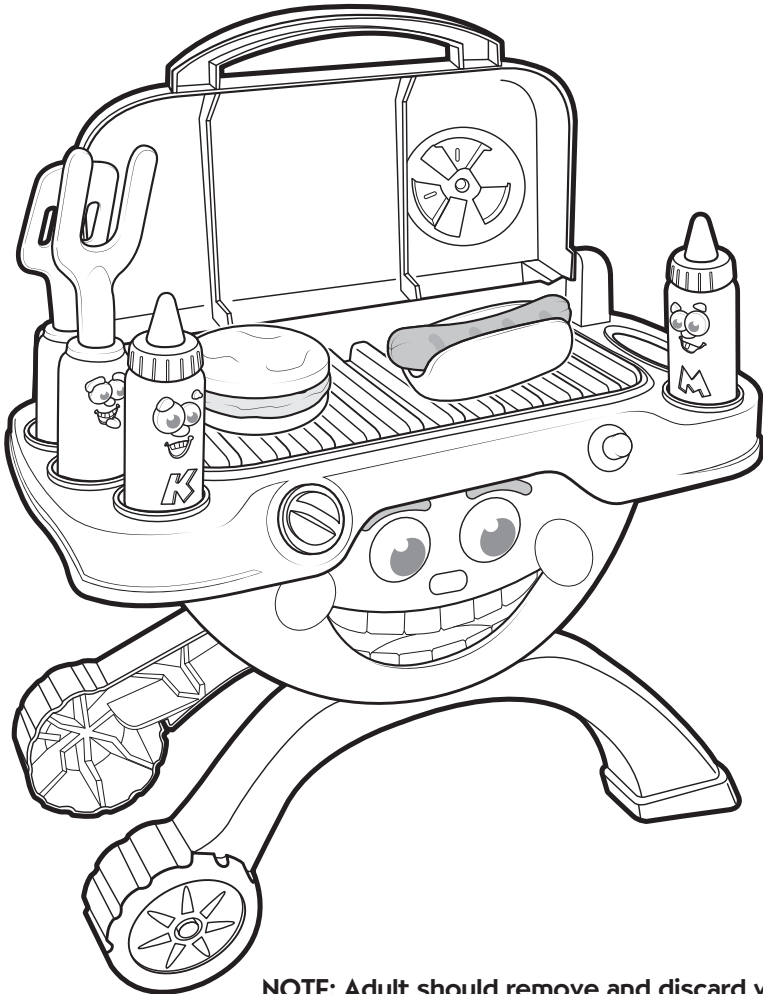

NOTE: Adult should remove and discard wire ties.

Thank you for choosing this unique PLAYSKOOL brand product!

Batteries included. Replace with 3 x 1.5V "AA" or LR6 size alkaline batteries.
Phillips/cross head screwdriver (not included) required to replace batteries.

TO ASSEMBLE

Connect the legs to the grill by snapping the pegs into the holes on the base. This is a one-time assembly.

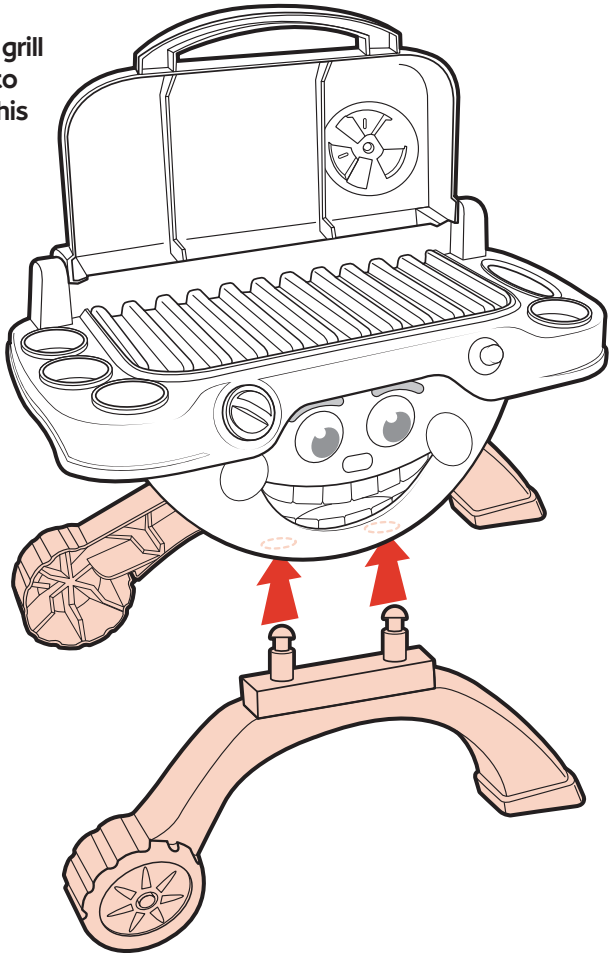

TO REPLACE BATTERIES

Use a Phillips/cross head screwdriver (not included) to loosen screw in battery compartment door as shown (screw remains attached to door). Remove and discard old batteries. Insert 3 fresh 1.5V "AA" or LR6 size alkaline batteries. Replace door and tighten screw.

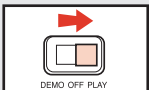
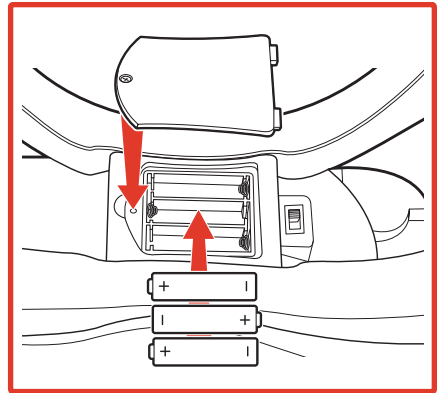

NOTE: This toy is packaged in "demo" mode. To enable full features, switch to "play" mode located on the bottom of the grill.

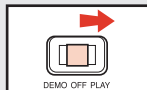

NOTE: The grill will automatically shut off after a period of inactivity. When storing toy, turn the switch to "OFF" to prevent accidental activation.

PLAY FEATURES

Preschoolers can pretend to grill up tasty food with the CHARLIE COAL THE GRILL toy. This lovable friend "comes to life" with sounds, animation, and fun activities!

This special toy says over 50 fun phrases and sounds. Here's how to activate them:

Press the front button to start speech and fun sound effects. Charlie Coal's eyes and mouth will also move!

Place a "food" item on the grill surface and lightly press on it to start speech and fun sound effects.

Place the ketchup, mustard, fork or spatula in the front holders as shown. The grill will recognize which accessory or condiment is in each holder and will talk to them! Items can also be placed in side holders for storage.

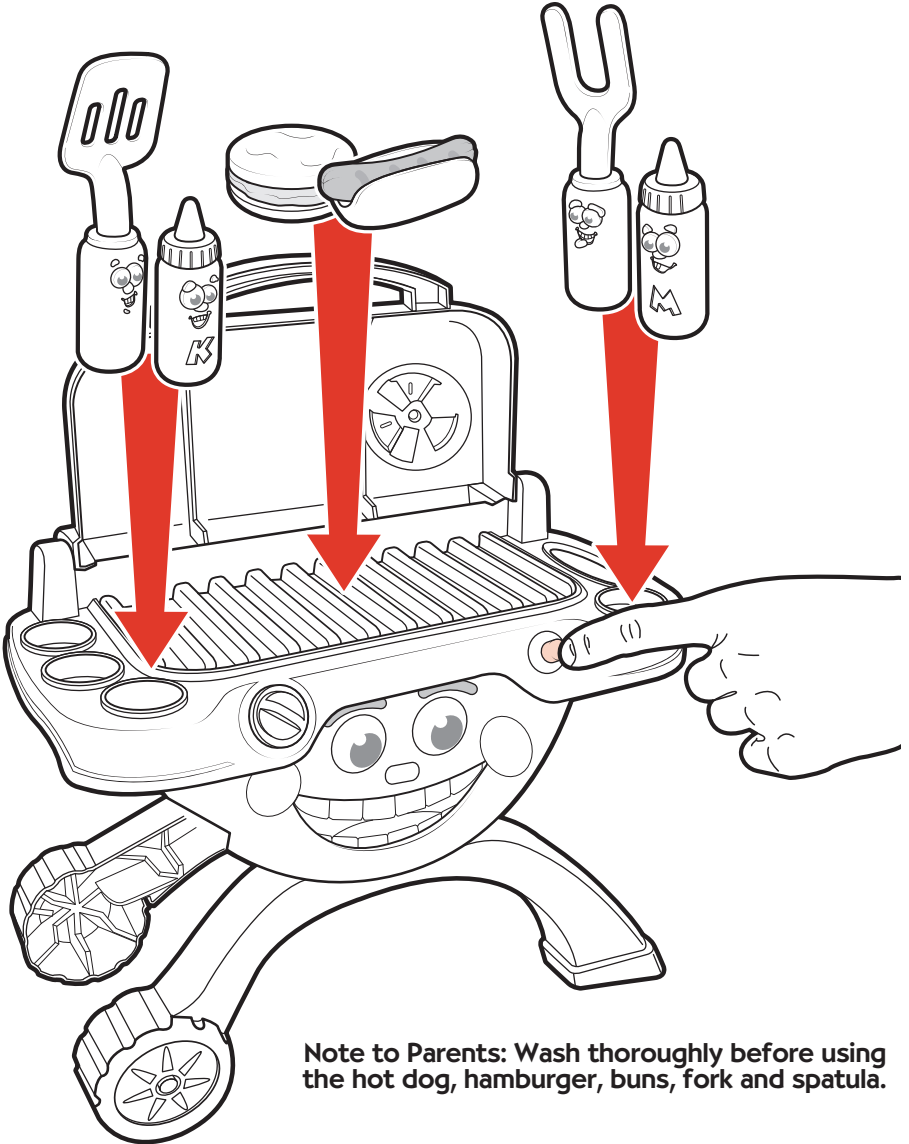

Note to Parents: Wash thoroughly before using the hot dog, hamburger, buns, fork and spatula.

This toy simulates the function of real workshop tools. Please caution your child about the hazards of real workshop tools.

CAUTION: TO AVOID BATTERY LEAKAGE

1. Be sure to insert the batteries correctly and always follow the toy and battery manufacturers' instructions;
2. Do not mix old and new batteries or alkaline, standard (carbon-zinc) or rechargeable (nickel-cadmium) batteries;
3. Always remove weak or dead batteries from the product.

IMPORTANT: BATTERY INFORMATION

Please retain this information for future reference.

Batteries should be replaced by an adult.

CAUTION:

1. Always follow the instructions carefully. Use only batteries specified and be sure to insert item correctly by matching the + and – polarity markings.
2. Do not mix old batteries and new batteries or standard (carbon-zinc) with alkaline batteries.
3. Remove exhausted or dead batteries from the product.
4. Remove batteries if product is not to be played with for a long time.
5. Do not short circuit the supply terminals.
6. Should this product cause, or be affected by, local electrical interference, move it away from other electrical equipment. Reset (switching off and back on again or removing and re-inserting batteries) if necessary.
7. RECHARGEABLE BATTERIES: Do not mix these with any other types of battery. Always remove from the product before recharging. Recharge batteries under adult supervision. **DO NOT RECHARGE OTHER TYPES OF BATTERIES.**

FCC Statement:

This equipment has been tested and found to comply with the limits for a Class B digital device, pursuant to part 15 of the FCC Rules. These limits are designed to provide reasonable protection against harmful interference in a residential installation. This equipment generates, uses and can radiate radio frequency energy, and, if not installed and used in accordance with the instructions, may cause harmful interference to radio communications. However, there is no guarantee that interference will not occur in a particular installation. If this equipment does cause harmful interference to radio or television reception, which can be determined by turning the equipment off and on, the user is encouraged to try to correct the interference by one or more of the following measures:

- Reorient or relocate the receiving antenna.
- Increase the separation between the equipment and receiver.
- Consult the dealer or an experienced radio/TV technician for help.



© 2005 Hasbro. All Rights Reserved.

TM & ® denote U.S. Trademarks.

08121 P/N 6509590000