

WARNING:
CHOKING HAZARD- Small parts.
Not for children under 3 years.

Chloe CHARMS™

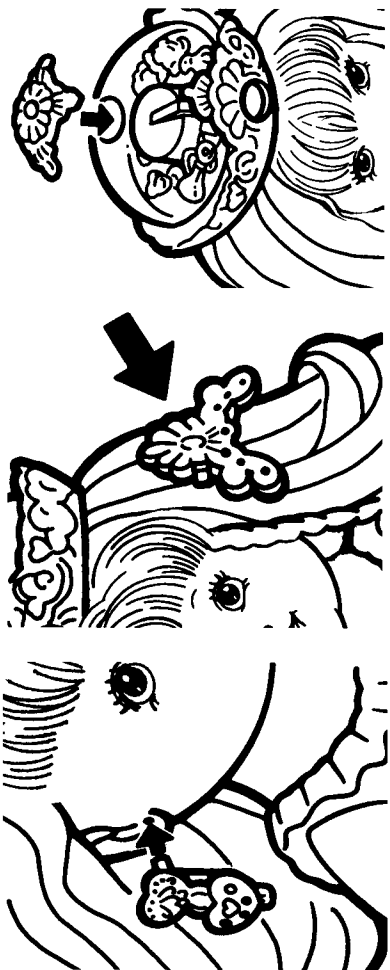

7. Insert posts on earrings into holes in doll's ears. You can slip the clips over your earlobes to wear the earrings, too!

8. Fasten barrette in doll's hair to create fun hair-styles. You can also wear the barrette in your hair!

CHARMS

9. Drop charms through hole in top of doll's crown. Insert plug into hole to close crown.



10. To remove charms from crown, turn crown in either direction until 1, 2 or 3 charms fall out of the hole (amount of charms will vary).

Now you can decorate Chloe Charms with the charms as shown. Hook each charm onto:

- Her skirt, earrings and barrette.
- The links on the locket chain.
- The doll's braid.

You can remove the charms and decorate the doll again and again to create lots of pretty looks!



Includes doll, skirt, shoes, 45 charms, 3 jewelry hooks, earring hooks, bracelet, locket, locket charm, key, ribbon, comb and instructions.

PLEASE NOTE:

- Remove accessories from poly-bags and discard bags immediately.
- To remove parts from runner frames, simply twist off. After removing parts, use safety scissors to trim all excess plastic.

WE REALLY DO CARE!

If you have any questions about this product, please call 1-800-327-8264, or write (include name, address and phone number):

Hasbro, Inc., Consumer Affairs, P.O. Box 200 Pawtucket, RI 02862-0200.

Product and colors may vary.

© 1995 HASBRO, INC., Pawtucket, RI 02862 USA. All Rights Reserved.
KENNER® is a trademark of Tonka Corporation, a subsidiary of Hasbro, Inc.
® denotes Reg. U.S. Pat. & TM Office. MADE IN CHINA.

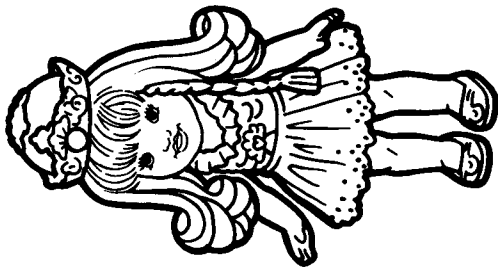

SKIRT AND SHOES

1. Slip doll's skirt onto her body. Place shoes on doll's feet (the shoes are designed to fit either foot).

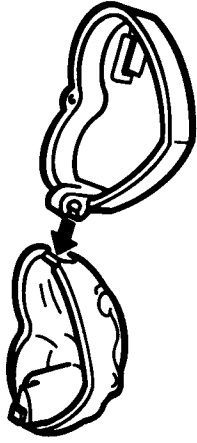

LOCKET AND SPECIAL CHARM

2. Snap locket front to hinge on locket back. Close locket.



4B. To open locket, insert key into key-hole and turn key in either direction.

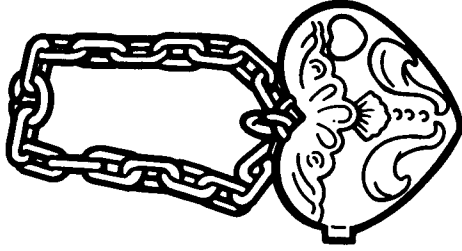

3A. Attach one jewelry hook to loop on locket. Attach hook to center link in chain. Attach last link on each end of chain to one jewelry hook.

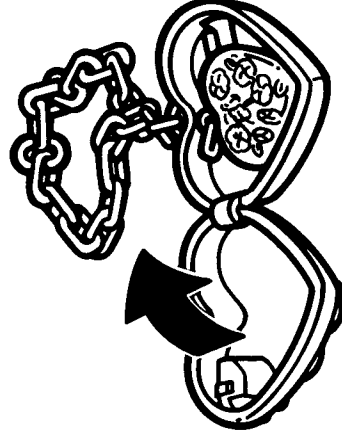

5. Attach a jewelry hook to large heart-shaped charm. Open locket, place charm inside and close locket.

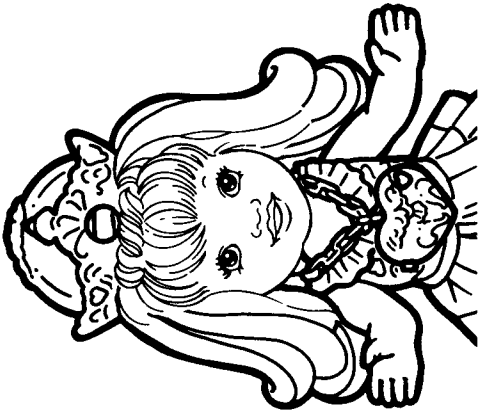

3B. The doll can wear the locket as a necklace, or you can wear it as a bracelet!

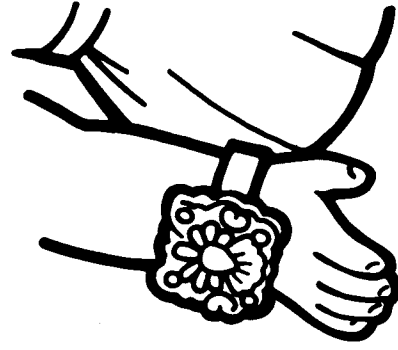

JEWELRY

6. Slip bracelet on doll's wrist. You can wear the bracelet as a ring!