

Connect Four[®]

AGE 7+ / For 2 Players

Contents: Grid • 21 Red Checkers • 21 Black Checkers

Before You Play for the First Time:

Assemble the tray to the grid by inserting the two nubs on the tray edge into the holes in the base of the grid. Repeat for the other tray. (See *Figure 1*).

Here's How to Play:

1. SETUP: Fold out the two trays and make sure the slider tab is in the middle of the grid. Place the checkers in the columns on the sides of the grid: black on one side, red on the other (See *Figure 2*).

2. GAMEPLAY: Place the grid between players. Players then alternate turns. On your turn, drop a checker of your color down any slot in the grid.

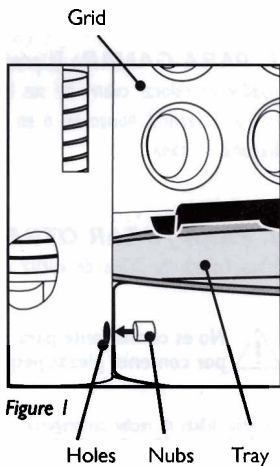

Figure 1

3. WINNING: The first player to get four of your checkers in a row -- vertically, horizontally or diagonally -- wins.

4. TO PLAY AGAIN: Push the slider to the side to release the checkers. Place the checkers back into the columns on the sides of the grid.

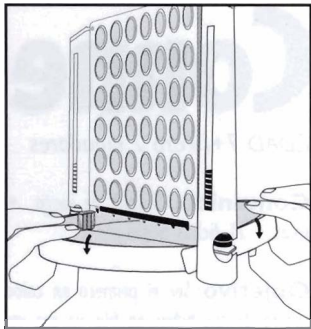

Figure 2



**Not suitable for children under 3 years
because of small parts – choking hazard**

We will be happy to hear your questions or comments about this game. US consumers please write to: Hasbro Games, Consumer Affairs Dept., P.O. Box 200, Pawtucket, RI 02862. Tel: 888-836-7025 (toll free). Canadian consumers please write to: Hasbro Canada Corporation, 2350 de la Province, Longueuil, QC Canada, J4G 1G2. European consumers please write to: Hasbro UK Ltd., Hasbro Consumer Affairs, P.O. BOX 43, Caswell Way, Newport, Wales, NP194YD, or telephone our Helpline on 00 800 2242 7276.

PROOF OF

Connect Four[®]

MB
MILTON
BRADLEY



04313

©2005 Hasbro, Pawtucket, RI 02862. All Rights Reserved.

TM and ® denote U.S. Trademarks



miltonbradley.com