

This toy simulates the function of household appliances. Please caution your child about the hazards of household appliances.

FCC STATEMENT

This equipment has been tested and found to comply with the limits for a Class B digital device, pursuant to part 15 of the FCC Rules. These limits are designed to provide reasonable protection against harmful interference in a residential installation. This equipment generates, uses and can radiate radio frequency energy, and, if not installed and used in accordance with the instructions, may cause harmful interference to radio communications. However, there is no guarantee that interference will not occur in a particular installation. If this equipment does cause harmful interference to radio or television reception, which can be determined by turning the equipment off and on, the user is encouraged to try to correct the interference by one or more of the following measures:

- Reorient or relocate the receiving antenna.
- Increase the separation between the equipment and the receiver.
- Consult the dealer or an experienced radio/TV technician for help.

AGES 2+
08764

PLAYSKOOL

Cool
Crew

DUSTY the
Talking Vacuum
Cleaner™

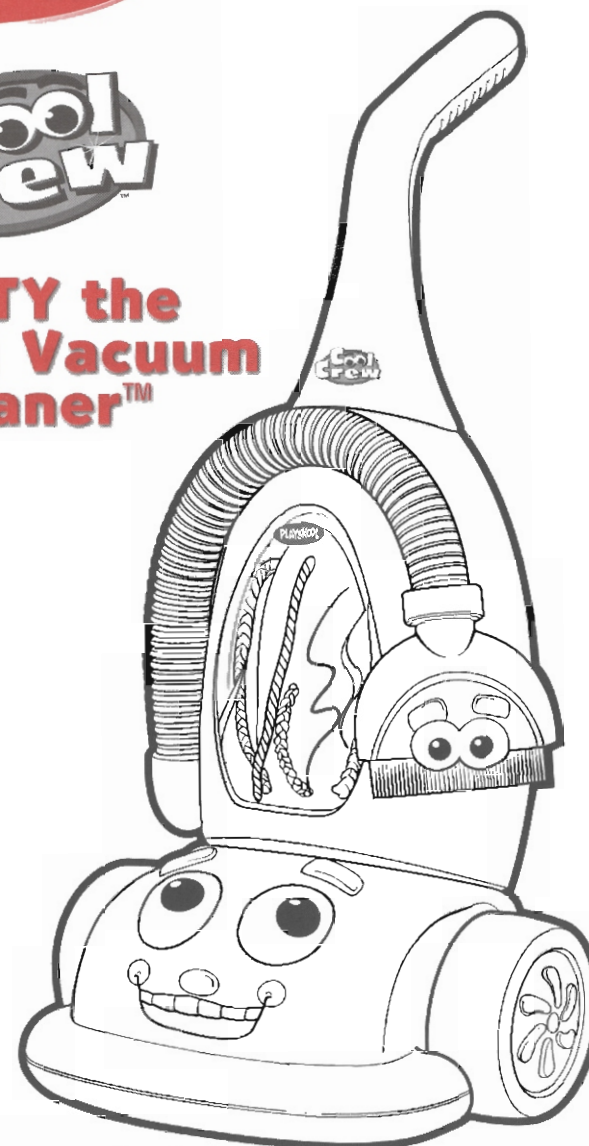

Adult Assembly Required

NOTE: Adult should remove and discard wire ties.

Thank you for choosing this unique PLAYSKOOL toy!

Batteries included. Replace with 3 x 1.5V "AA" or R6 size batteries. Alkaline batteries recommended. Phillips/cross head screwdriver (not included) required to replace batteries.



© 2005 Hasbro. All Rights Reserved.
TM & ® denote U.S. Trademarks
08764 P/N 6534290000

ATTACH HANDLE

Snap handle into vacuum as shown. You may or may not hear a "click" once the handle is in place. Regardless of whether an audible "click" is heard, it is important to test to determine if the handle is secured.

TO TEST HANDLE: With the handle in place and vacuum on the floor, pull lightly on the handle several times to see if it can be removed. If the handle remains in place, then the handle is secure. If handle can be removed, push the handle into place again with increased pressure. Test until handle is securely in place.

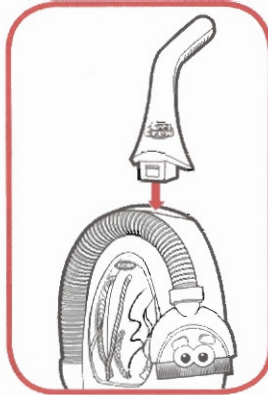

PLAY FEATURES

This electronic, talking vacuum cleaner "comes alive" with animation, realistic sounds and fun activities!

- Free-rolling wheels activate speech and vacuum sounds!
- Eyes move as vacuum rolls!
- Barrel spins... "lint" swirls inside!
- 2 interactive personalities! BRUSHY and DUSTY talk to each other!
- Button activates speech and sounds!
- Vacuum cleaner pivots up and down... just like a real one!

"Is that a rabbit?"

"Na! It's just a dust bunny."

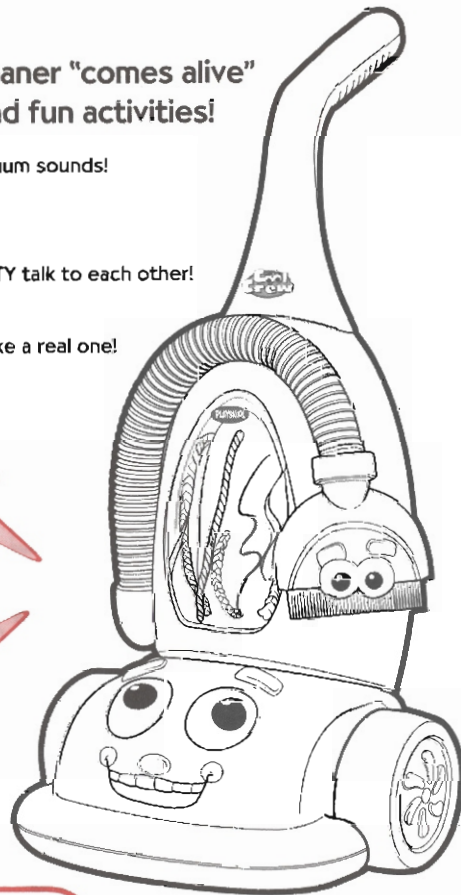

Tethered brush clips onto vacuum cleaner for storage!

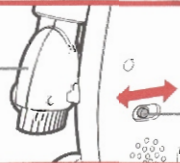

Note: When storing toy, turn the switch to "OFF" to prevent accidental activation. If toy does not respond, reset by moving the switch to off, then on.

TO REPLACE BATTERIES

Using a Phillips/cross head screwdriver (not included), loosen screw in battery cover (screw will remain attached to cover). Remove and discard old batteries. Insert 3 fresh 1.5V "AA" or R6 size batteries into battery compartment. Alkaline batteries recommended. Replace cover and tighten screw.

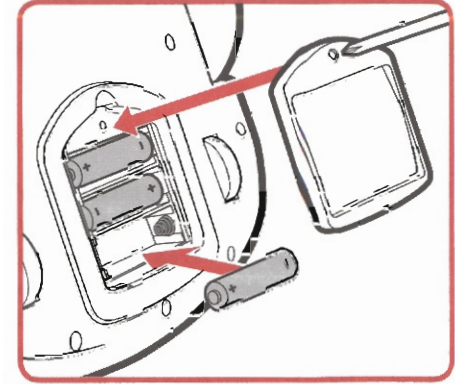

⚠ CAUTION: TO AVOID BATTERY LEAKAGE

1. Be sure to insert the batteries correctly and always follow the toy and battery manufacturers' instructions;
2. Do not mix old and new batteries or alkaline, standard (carbon-zinc) or rechargeable (nickel-cadmium) batteries;
3. Always remove weak or dead batteries from the product.

IMPORTANT: BATTERY INFORMATION

Please retain this information for future reference.

Batteries should be replaced by an adult.

⚠ CAUTION:

1. Always follow the instructions carefully. Use only batteries specified and be sure to insert item correctly by matching the + and - polarity markings.
2. Do not mix old batteries and new batteries or standard (carbon-zinc) with alkaline batteries.
3. Remove exhausted or dead batteries from the product.
4. Remove batteries if product is not to be played with for a long time.
5. Do not short circuit the supply terminals.
6. Should this product cause, or be affected by, local electrical interference, move it away from other electrical equipment. Reset (switching off and back on again or removing and re-inserting batteries) if necessary.
7. RECHARGEABLE BATTERIES: Do not mix these with any other types of battery. Always remove from the product before recharging. Recharge batteries under adult supervision. DO NOT RECHARGE OTHER TYPES OF BATTERIES