

**AGES 3+**  
**00152/00160 Asst.**

**PLAYSKOOL**

# **Flip 'n Play™ Flashlight**

**Thank you for choosing this PLAYSKOOL brand toy!**

**Requires 2 x 1.5V  
"C"/LR14 alkaline  
batteries (not  
included).  
Phillips/cross head  
screwdriver (not  
included) required  
for battery  
installation.**

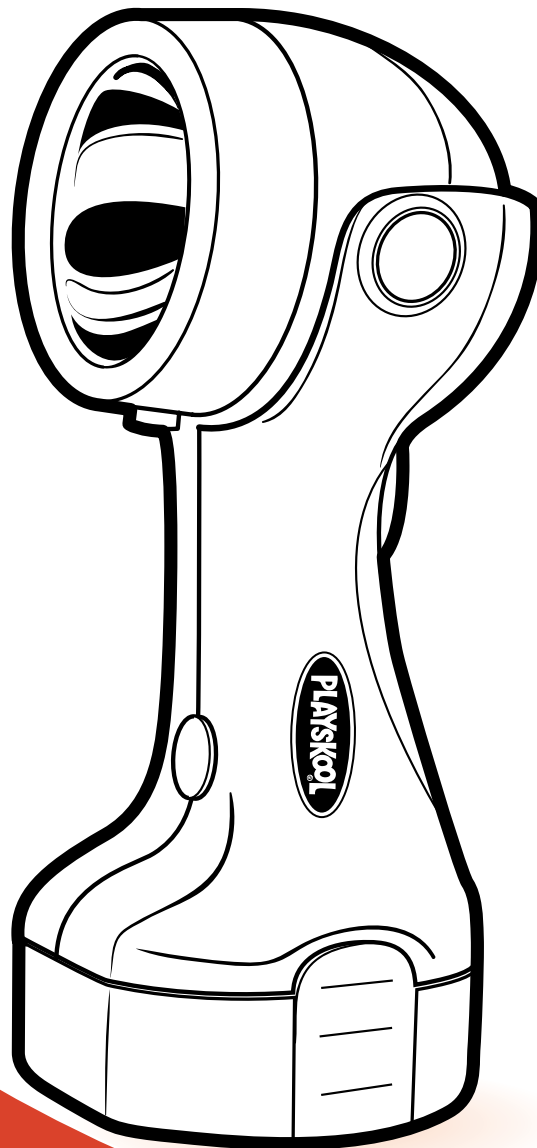

## To Install Batteries

Using Phillips/cross head screwdriver, loosen 2 screws in battery compartment door (screws stay attached to door). Remove cover. Insert 2 x 1.5V "C"/LR14 alkaline batteries. Replace door and tighten screws.

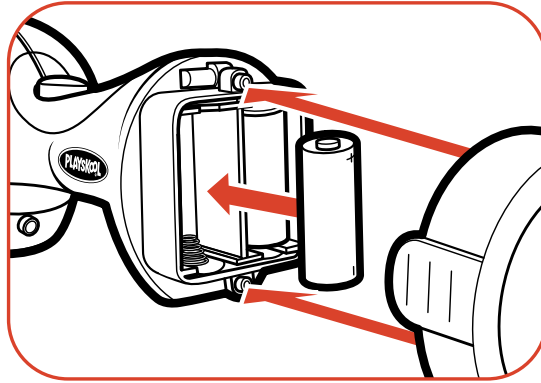

### **CAUTION: TO AVOID BATTERY LEAKAGE**

1. Be sure to insert the batteries correctly and always follow the toy and battery manufacturers' instructions;
2. Do not mix old batteries and new batteries or alkaline, standard (carbon-zinc) or rechargeable (nickel-cadmium) batteries;
3. Always remove weak or dead batteries from the product.

### **IMPORTANT: BATTERY INFORMATION**

Please retain this information for future reference.

Batteries should be replaced by an adult.

### **CAUTION:**

1. Always follow the instructions carefully. Use only batteries specified and be sure to insert them correctly by matching the + and - polarity markings.
2. Do not mix old batteries and new batteries or standard (carbon-zinc) with alkaline batteries.
3. Remove exhausted or dead batteries from the product.
4. Remove batteries if product is not to be played with for a long time.
5. Do not short circuit the supply terminals.
6. Should this product cause, or be affected by, local electrical interference, move it away from other electrical equipment. Reset (switching off and back on again or removing and re-inserting batteries) if necessary.
7. **RECHARGEABLE BATTERIES:** Do not mix these with any other types of battery. Always remove from the product before recharging. Recharge batteries under adult supervision. **DO NOT RECHARGE OTHER TYPES OF BATTERIES.**

## To Play

This colorful flashlight looks and works just like Dad's, but is made for a preschooler!

- Adjust the 5-position pivoting head to shine the light just right!
- The extra wide base allows the flashlight to stand-up for lantern play!
- Each press of the "ON" button turns on the light for approximately 30 seconds. The light even dims as it shuts off! Press the "OFF" button to shut off the light immediately.

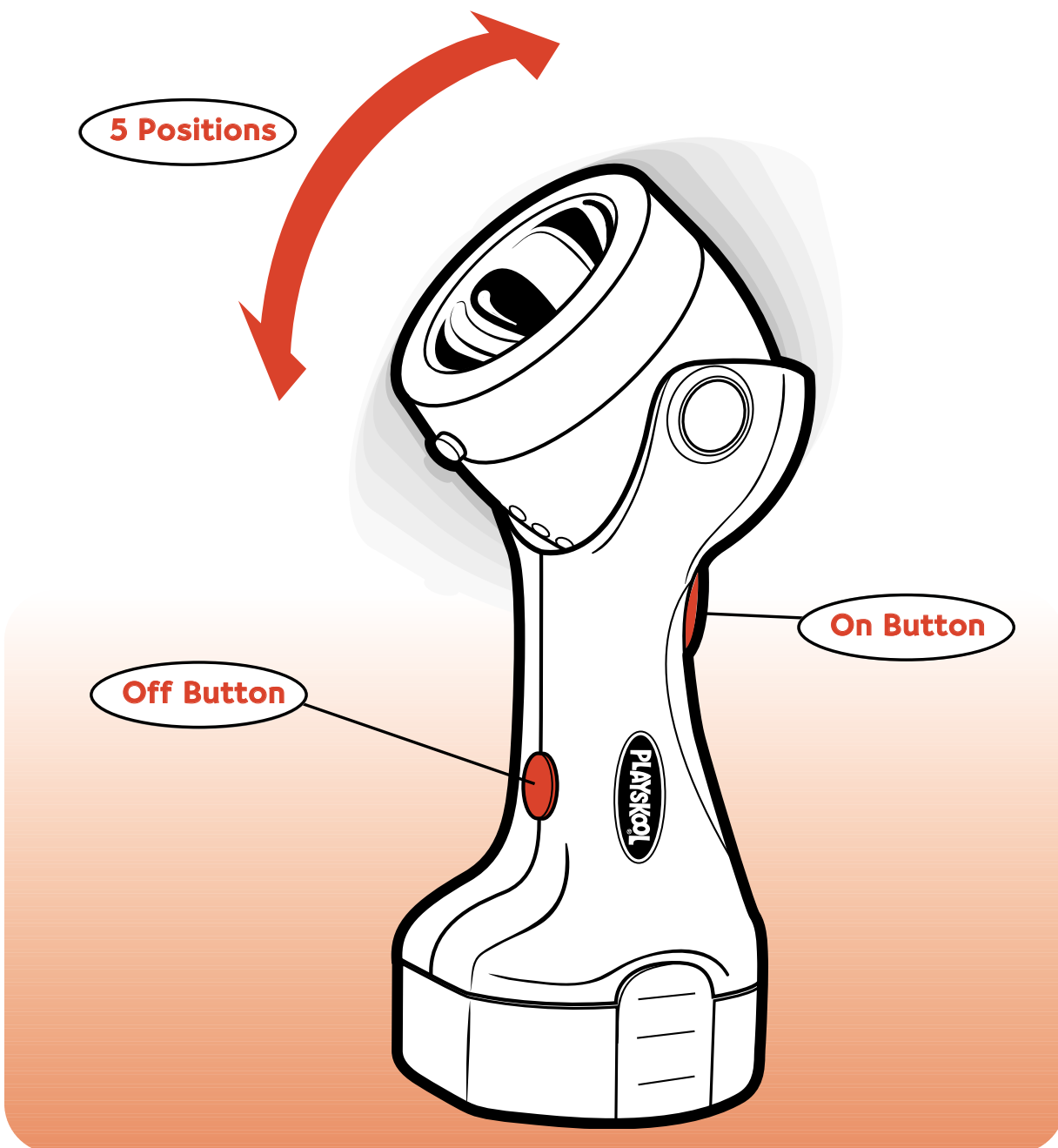

## To Replace Light Bulb

PR6 or PR2 bulb required.

Using Phillips/cross head screwdriver, loosen screw on lens piece (screw stays attached). Remove lens piece. Rotate bulb holder 1/4 turn counterclockwise, then pull out and remove. Replace old bulb with a new PR6 or PR2 bulb. Fit bulb holder into place over new bulb, then rotate 1/4 turn clockwise to secure. Replace lens piece, align screw holes and retighten screw.

