

Fold 'n Go Busy Floor Gym™

3694
Birth-18 mos.

8 fun activities . . . 5 happy sounds!

Dear Parent,

Thank you for purchasing this unique, high quality product from Playskool. During baby's first few months, this toy provides visual stimulation with bright, colorful characters that are height adjustable and specially angled for baby's view. As your child gets older, he or she will be able to touch and swing the friendly animals and listen to the fun sounds they make. For take-along play, simply remove the characters from the gym. Whether your baby is in an infant seat, lying on the floor, or sitting up, Fold 'n Go Busy Floor Gym is the perfect place to play!

**Adult assembly required. No tools needed.
Not for use in crib or playpen. Adult supervision required.**

PARTS LIST:

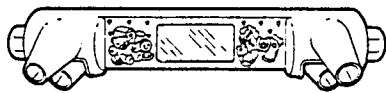

HOUSING ASSEMBLY



LEFT FRONT LEG

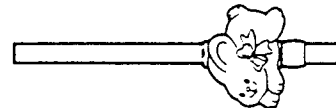

RIGHT FRONT LEG



REAR LEGS (2)



ATTACHABLE CHARACTERS (3)



FRONT FEET (2)



REAR FEET (2)

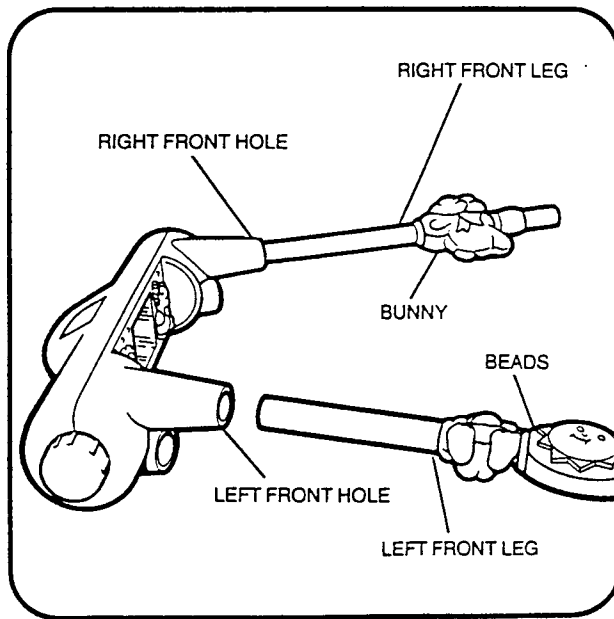
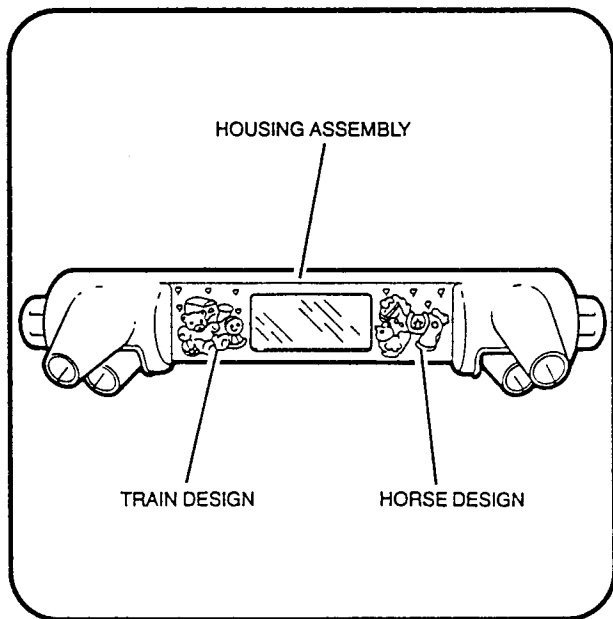

TO ASSEMBLE

Please Note: Remove cardboard packing from front legs, making sure that bunny on right leg and beads on left leg remain in place.

1. Place housing assembly on a flat surface, with horse and train designs as shown.

2. Slide right front leg (with bunny) into right front hole in housing assembly. Turn leg until you feel it lock into place. Repeat for left front leg (with beads).

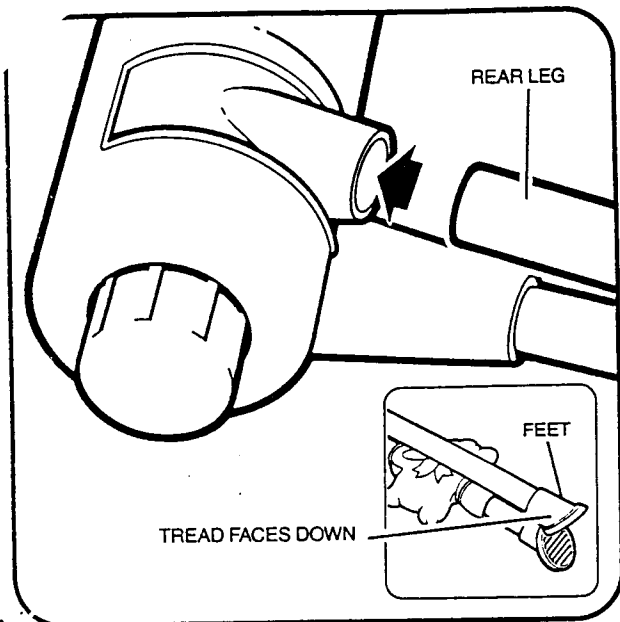

3. Turn housing assembly onto reverse side. Slide rear leg into hole, then turn leg until you feel it lock into place. Repeat for other rear leg.
 Test to ensure all legs are secure by tugging on them. Push front feet (marked "F") onto front legs, and rear feet (marked "R") onto rear legs as far as they can go. Then, twist feet so that tread faces down as shown.

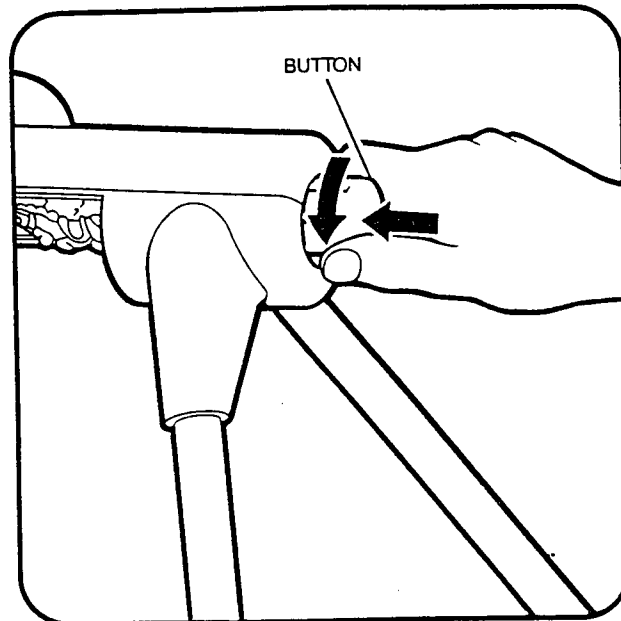

4. To open gym, rest assembly on its legs, then press button in and rotate to open legs. When opened, the gym should be upright and the legs should rest firmly on the floor. To ensure this, check to see that the tread on each foot faces down as shown in the illustration directly below. It may be necessary to twist feet to properly position them.

To fold gym for easy carrying and storage, press and rotate housing buttons to close legs together.

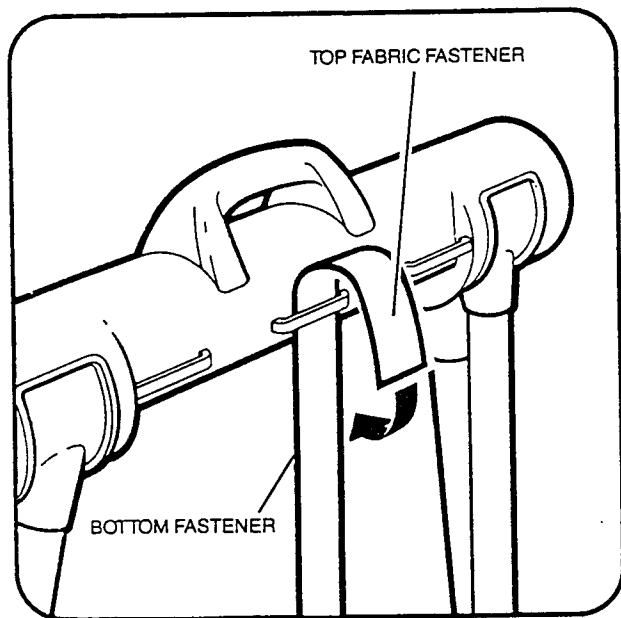

5. To fasten character to housing assembly, slide the character's top fabric fastener through the slot on the housing assembly and press it onto the bottom fastener as shown.
 Characters can be raised by sliding more of the strap through the slot. The fabric fastener will adhere to any part of the strap.
 Characters are removable for take-along play. Puppy and kitty are machine washable and dryer safe.

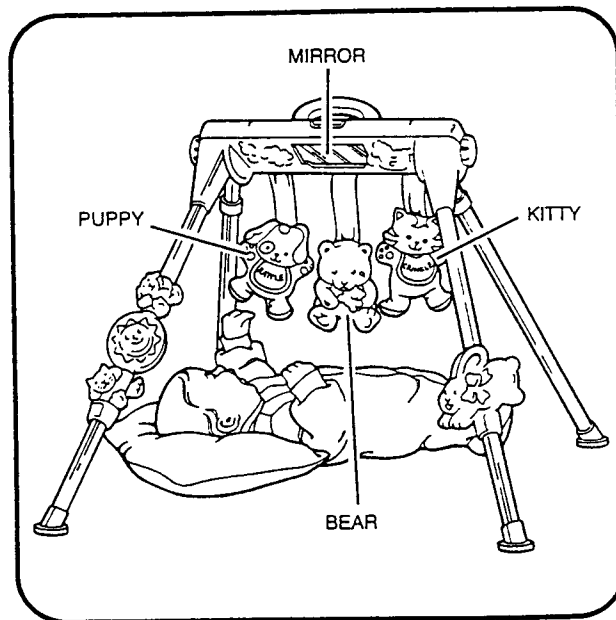

PLAY FEATURES

- Specially tilted mirror and characters are easy for baby to see
- Bear CHIMES & SQUEAKS
- Puppy RATTLES
- Kitty CRINKLES
- Spinning bunny RATTLES
- Sliding, spinning beads



Questions? Call:
1-800-PLAYSKL™