

ITEM NO.51610
AGES 5+

CAUTION - ELECTRIC TOY:
NOT RECOMMENDED FOR CHILDREN UNDER 5 YEARS OF AGE. AS WITH ALL ELECTRIC PRODUCTS, PRECAUTIONS SHOULD BE OBSERVED DURING HANDLING AND USE TO PREVENT ELECTRIC SHOCK. INPUT: AC120V, 60HZ OUTPUT: DC9.0V 200MA

SPYROOPS™

Hoverstrike™

with **Mirage™**

INSTRUCTIONS

Includes unassembled vehicle, pilot figure, transmitter, steering handle, 2 stabilizer wings, 6 missiles, 7.2V rechargeable battery, charger and instructions.

CAUTION:
Do not aim at eyes or face. To Avoid Injury: Use only missiles designed for this product. Do not modify missiles or missile launcher.

CAUTION:
Hair entanglement may result if child's hair comes in contact with moving parts of toy. Adult supervision is required.

ASSEMBLING YOUR GI JOE® HOVERSTRIKE™

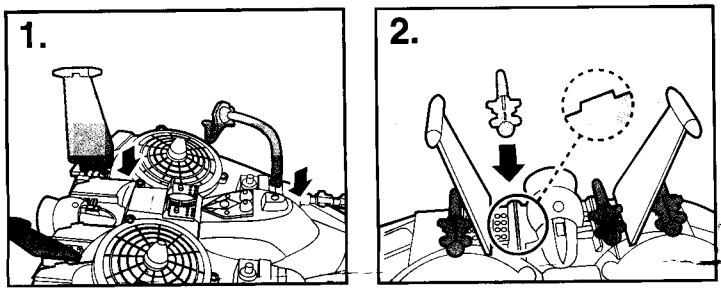

1. Attach stabilizer wing and steering handle.
2. Attach missiles to vehicle.

USING ACTION FIGURES AND LAUNCHING MISSILES

Your vehicle is equipped so that you can use GI JOE® and many other popular action figures.
Your GI JOE® HOVERSTRIKE™ comes with several spare missiles for launching.

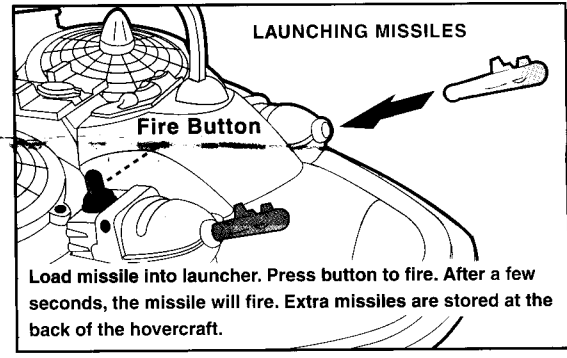

BATTERY INSTALLATION

DRIVING YOUR GI JOE® HOVERSTRIKE™

Welcome to the GI JOE® HOVERSTRIKE™ radio controlled vehicle designed to work with your favorite action figures. In order to get the most enjoyment from your new toy, please read the following instructions carefully.

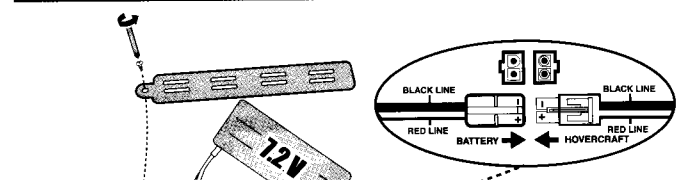

CONTROLLING YOUR HOVERCRAFT

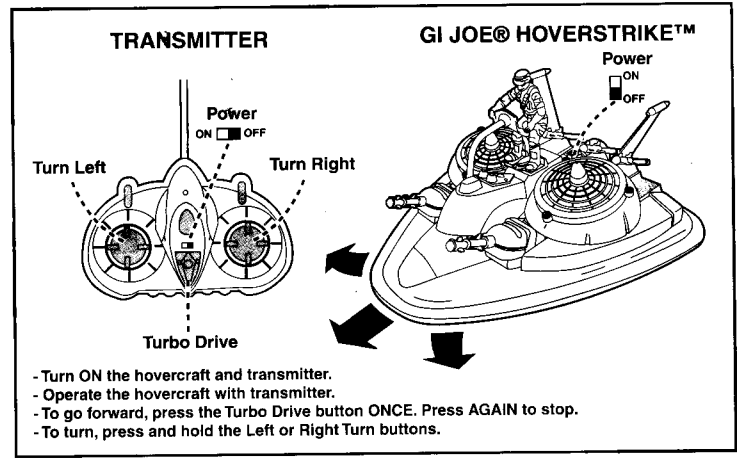

- 2-Speed Turning**
Using the Turbo Drive button, you can turn the hovercraft at 2-Speeds.
- Press Turbo Drive once for super-fast hairpin turns.
 - Press Turbo Drive again for precision turns on the spot.

NOTE: If no button is pressed for approx. 5 minutes after activating Turbo Drive, the hovercraft will start auto power-save and only hover on the spot. To reactivate, turn the hovercraft "OFF" then back to "ON" again.

- To Insert Batteries in Vehicle**
- Use a Phillips / crosshead screwdriver (not included) to open the battery door
 - Join the connectors of the 7.2V Ni-MH rechargeable battery pack (included) and the vehicle
 - Replace the battery door and use a Phillips / crosshead screwdriver to close it
 - Remove the battery from the vehicle after playing

- To Insert Batteries in Transmitter**
- Use a Phillips / crosshead screwdriver (not included) to open the battery door
 - Install one 9V/6LR61 battery (not included) and replace door
 - Make sure + and - poles of the battery are positioned properly
 - Replace battery door and use a Phillips / crosshead screwdriver to close it

Note:
Quality of control function may deteriorate when battery power is low.

RECHARGING

Your GI JOE® HOVERSTRIKE™ is powered by a 7.2V Ni-MH rechargeable battery pack (included). Make sure you fully charge the rechargeable battery pack before you play. Average charging time is approximately 6 hours.

WARNING:

- Do not remove warm or hot power packs. Wait 20 min, until pack has cooled. Recharging too early will shorten pack life.
- Recharging near fire or high temperature is dangerous.
- Do not recharge packs that show wear or leakage.
- Always unplug power pack when not in use.
- Do not dispose of packs in fire, explosion or personal injury may occur.
- Dispose of power packs properly, do not disassemble.
- Always remove power pack from vehicle before charging.
- Do not use charger for any use other than instructed in directions.
- Do not dispose of this product in fire. Batteries inside this product may explode or leak.

- Join the connector of the charger to the connector of the 7.2V Ni-MH rechargeable battery.
- Plug the charger into an electrical outlet.
- Average charging time is approximately 6 hours.
- After charging for 6 hours, the battery pack will feel warm. This is normal for fully charged batteries.
- When the recharging is over, unplug the charger from the electrical outlet and detach the connector.

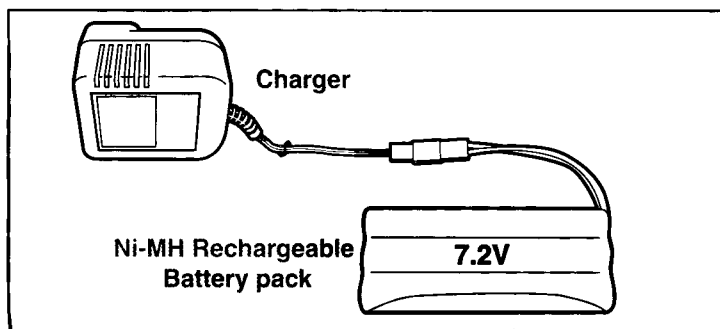

IMPORTANT: BATTERY INFORMATION

Charger and Battery Specifications :

- Charger : Input - AC 120V 60HZ
: Output - DC 9.0V 200mA
Battery : Vehicle - one 7.2V Ni-MH rechargeable battery pack

CAUTION: TO AVOID BATTERY LEAKAGE

- * Be sure to insert the batteries correctly and always follow the toy and battery manufacturers' instructions;
- * Do not mix old batteries and new batteries or alkaline, standard (carbon-zinc) or rechargeable (nickel-cadmium) batteries;
- * Always remove weak or dead batteries from the product.

IMPORTANT: BATTERY INFORMATION

Please retain this information for future reference. Batteries should be replaced by an adult. Parent should examine the unit and charger periodically, in case there is any damage, the toy must not be used until that damage has been properly repaired.

CAUTION:

1. Always follow the instructions carefully. Use only batteries specified and be sure to insert item correctly by matching the + and - polarity markings.
2. Do not mix old batteries and new batteries or standard (carbon-zinc) with alkaline batteries.
3. Remove exhausted or dead batteries from the product.
4. Remove batteries if product is not to be played with for a long time.
5. Do not short-circuit the supply terminals.
6. Should this product cause, or be affected by, local electrical interference, move it away from other electrical equipment. Reset (switching off and back on again or removing and re-inserting batteries) if necessary.
7. RECHARGEABLE BATTERIES: Do not mix these with any other types of battery. Always remove from the product before recharging. Recharge batteries under adult supervision. DO NOT RECHARGE OTHER TYPES OF BATTERY.

CLEANING AND MAINTENANCE HINTS

- Brush areas where dirt and dust get trapped.
- Wipe body off with a soft rag or tact cloth.
- Do not clean with chemicals or water.

Care and use maintenance:

- Clean the unit with a soft, damp cloth.
- Please do not put the unit in direct sunlight or near any source of heat.
- Please remove the battery if you won't be using the unit for a long period of time.
- Do not use any chemical solvent to clean the unit.
- Do not spill anything on the unit.
- Do not immerse in water.

SAFETY

1. Do NOT operate your vehicle over wet surfaces. Water can damage the internal electronic assemblies.
 2. Do NOT drive your remote control vehicle into the streets.
- Keep vehicle away from wet surfaces or rain. If your vehicle ACCIDENTALLY gets wet and stops running, let it dry overnight before trying to run it again.
 - Keep vehicle away from sandy, dusty areas.
 - Electronic instruments are sensitive to direct sunlight or heat.
 - Avoid long periods of play under direct sunlight.

DEFECT OR DAMAGE

If GI JOE® HOVERSTRIKE™ is damaged or something has been left out, DO NOT RETURN IT TO THE STORE. The store doesn't have the replacement parts. Instead, write to us at:

Hasbro Inc.
PO Box 220, Pawtucket, RI 02862

In your note, mention the name of your toy, its model number, and tell us briefly what the problem is. Also include sales slip, date, place of purchase and price paid. We will do our best to help.

FCC STATEMENT:

This device complies with Part 15 of the FCC Rules. Operation is subject of the following two conditions:

- (1) This device may not cause harmful interference, and
- (2) This device must accept any interference received, including interference that may cause undesired operation.

Changes or modifications to this unit not expressly approved by the party responsible for compliance could void the user's authority to operate the equipment.

©2003 Hasbro.
All Rights Reserved.
® denotes Reg. U.S. Pat. & TM Office.
www.hasbro.com

st51610us01

PRINTED IN CHINA.

