



# MAGIC SIZZLING GRILL™

Thank you for purchasing the Playskool Magic Sizzling Grill™!

Includes: Grill with lid and vent, storage door, tongs, spatula, fork, 2 pretend hot dogs with buns, label sheet and instruction sheet.

Phillips screwdriver and slotted screwdriver needed for battery placement.

## TO INSERT BATTERIES

1. The battery compartment is located inside the top of the grill. Use a Phillips screwdriver to loosen the screw that secures the battery door, and remove door.
2. Place 2 "AA" batteries (alkaline recommended) in battery compartment as shown. Replace door and tighten screw. Make sure batteries are inserted correctly for proper operation.
3. Place grill rack on grill and tighten screw with a slotted screwdriver.

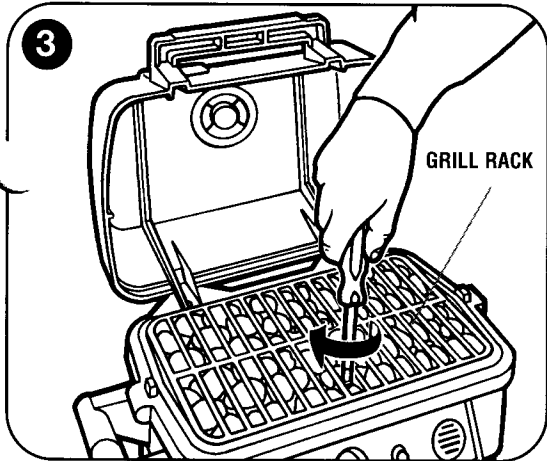
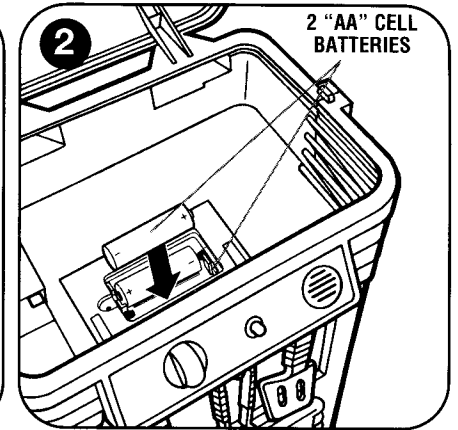
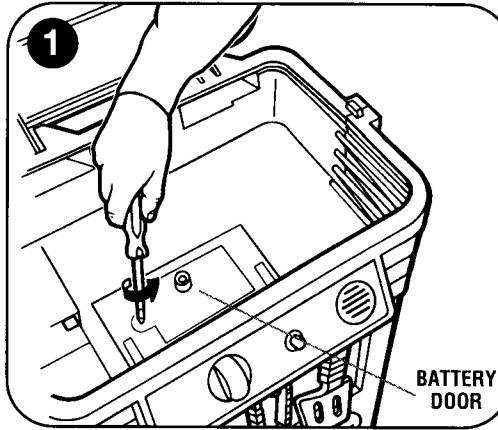

## CAUTION: TO AVOID BATTERY LEAKAGE:

1. Be sure to insert the batteries correctly and always follow the toy and battery manufacturers' instructions.
2. Never mix old batteries and new batteries, or alkaline, standard (carbon-zinc) or rechargeable batteries.
3. Always remove exhausted or dead batteries from the product.

## ASSEMBLY & LABEL PLACEMENT

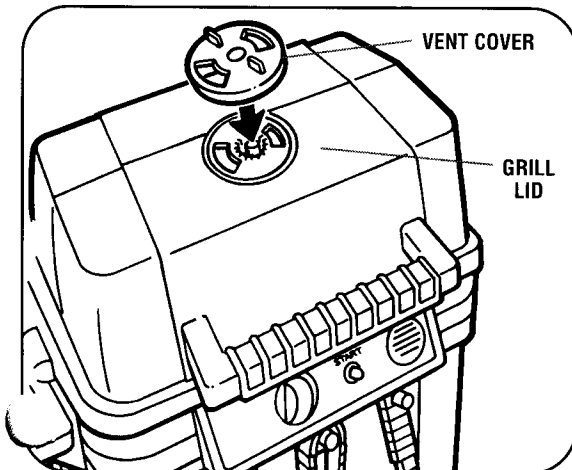

1. Snap vent cover into grill lid as shown.

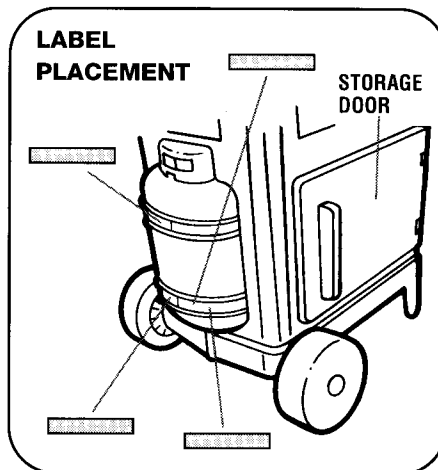

2. Assemble storage compartment door to front of grill, snapping the top hinge into place at an angle, then snapping the bottom hinge into place to complete the assembly. Test door to be sure it swings back and forth freely on hinges.
3. Peel and apply labels as shown.

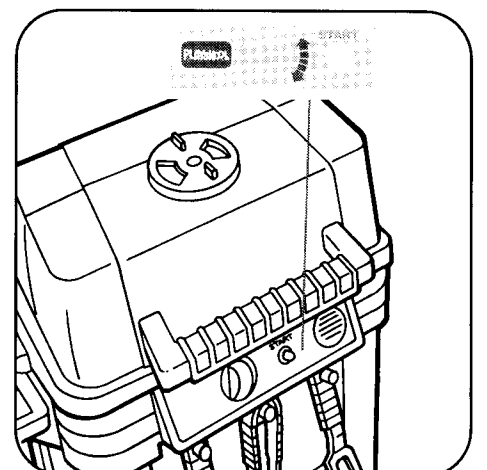

## ACTIVATION AND PLAY FEATURES

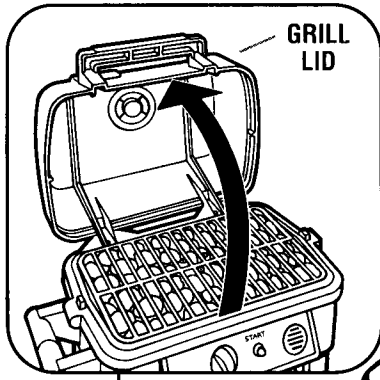

1. Lift grill lid and place hot dogs and buns on top of grill.
2. Press **START** button to activate sizzling sounds.

**Note:** When raising or lowering the lid, be careful not to drop it on hands or fingers.

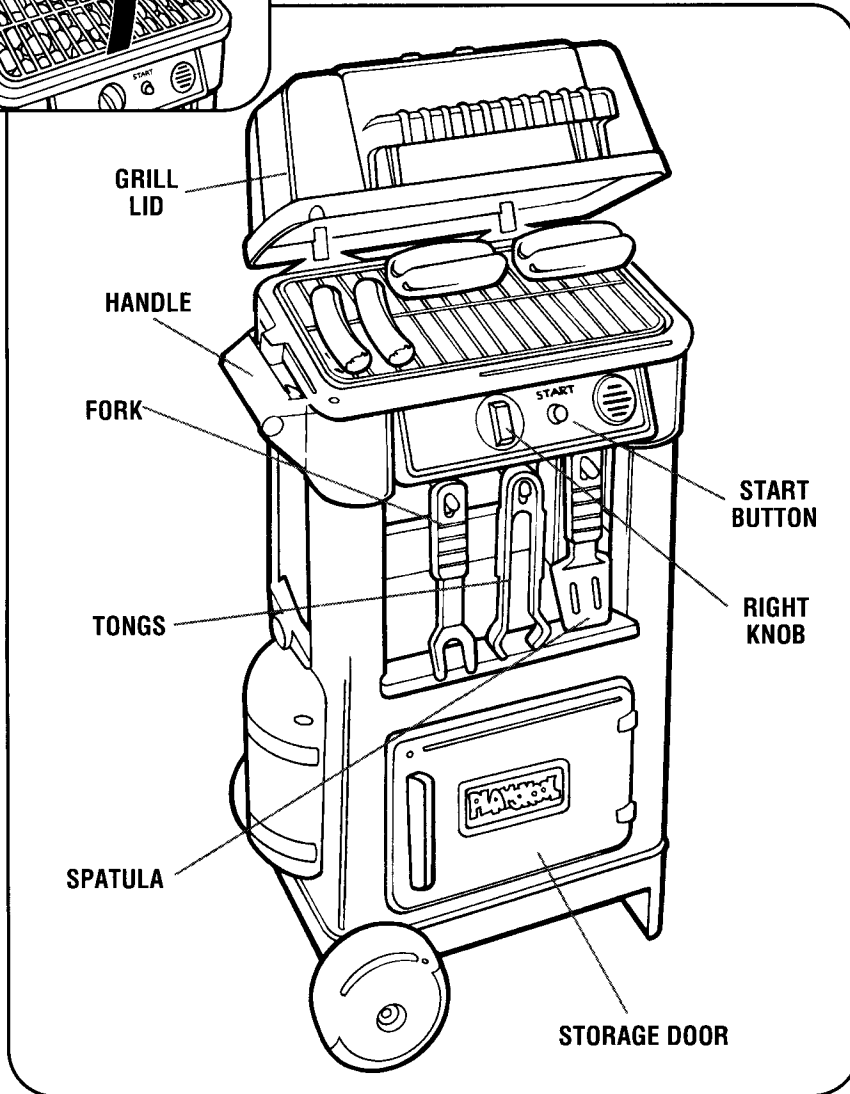

- You can hold a hot dog in the tongs, or fit it between the fork tines.
- You can use the utensils to place food on the grill or remove food when finished "cooking." When not using utensils, hang them on the hooks located on the front of the grill.
- Open the storage door to store accessories when finished playing.
- The knob to the left of the "START" button makes a fun clicking sound when you turn it.

**NOTE:** When finished playing, place the Magic Sizzling Grill™ in a cool, dry place. Do not leave it outside or allow it to get wet.

### FCC STATEMENT

This equipment has been tested and found to comply with the limits for a Class B digital device, pursuant to Part 15 of the FCC Rules. These limits are designed to provide reasonable protection against harmful interference in a residential installation. This equipment generates, uses, and can radiate radio frequency energy and, if not installed and used in accordance with the instructions, may cause interference to radio communications. However, there is no guarantee that interference will not occur in a particular installation. If this toy does cause harmful interference to radio or television reception, which can be determined by turning the equipment off and on, the user is encouraged to try to correct the interference by one or more of the following measures:

- Reorient or relocate the receiving antenna.
- Increase the separation between the equipment and the receiver.
- Consult the dealer or an experienced radio/TV technician for help.

© 1996 Hasbro, Inc., Pawtucket, RI 02862 USA. All Rights Reserved.

® denotes Reg. U.S. Pat. & TM Office.

**ASSEMBLED IN U.S. FROM US AND CHINESE COMPONENTS.**

783

P/N 47012300

