

# NEW KIDS ON THE BLOCK™

**REAL**

# TELEPHONE

## Instructions

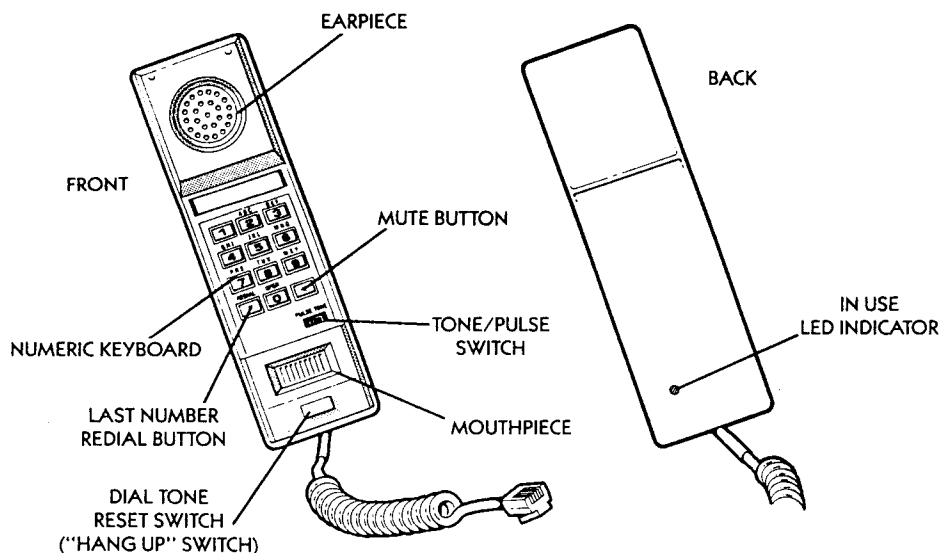

### TO ATTACH TELEPHONE:

(A) To attach telephone to a modular phone jack, insert the modular plug.  
 (B) To attach telephone to a 4-prong receptacle, use a 4-prong receptacle adaptor between the modular plug and the receptacle.



MODULAR

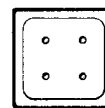

4-PRONG

### TONE/PULSE SWITCH:

(A) Use the Tone feature in areas where tone dialing service is available. To select the Tone feature, switch the Tone/Pulse Switch to Tone.  
 (B) Use the Pulse feature in areas where the pulse dialing service is available. To select the Pulse feature, switch the Tone/Pulse Switch to Pulse.

### RECEIVING A CALL:

When the telephone rings, pick it up and use it like a standard telephone.

### MAKING A CALL:

1. Pick up the phone, and listen for a dial tone. The IN USE light will light up.
2. Press the buttons to key in the number you want to call. Dialing will start after the first digit had been entered. The IN USE light will flash on and off while dialing is in progress.
3. To hang up the phone when your call is finished, put the phone face down on a flat surface. Make sure the IN USE light stops glowing; this means that your call has been properly disconnected.

### AUTOMATIC REDIAL:

You can automatically redial the last number you called. Simply pick up the phone, listen for the dial tone, and press the # button once.

### MUTE BUTTON:

To "hold" the call, press the mute button — the person is still on the line but cannot hear you. You must keep pressing the mute button to keep the person on "hold." To take the person off "hold", remove your finger from the mute button.

### WALL MOUNT:

Instead of placing the phone on a flat surface when you're not using it, you can mount the phone on a wall using the wall mount. Attach the wall mount to a wall with two #4 sheet metal screws, 1/2" or 3/4" length, (not included) in the position shown. Slide the phone into the wall mount when not using the phone.

