

NERF® PRO HOOP™ GAME

For ages 5 and up

Instructions © 1991 Parker Brothers, Division of Tonka Corporation, Beverly, MA 01915.

Equipment

Two-sided Backboard • Hoop Adjustment Bracket • Strap • 2 Door Clamps • Hoop • Net • Ball

Note: The NERF® PRO HOOP™ game will fit any standard interior door 1-3/8" to 1-3/4" thick.

Assembly

Perform steps in this order:

Step 1. Backboard and Hoop Adjustment Bracket:

With the side of the Backboard you want facing you, push Bracket through hole from the back, leading with its top edge while pressing down and sliding the top edge of the opening down into the slots; make sure it "snaps" in place.*

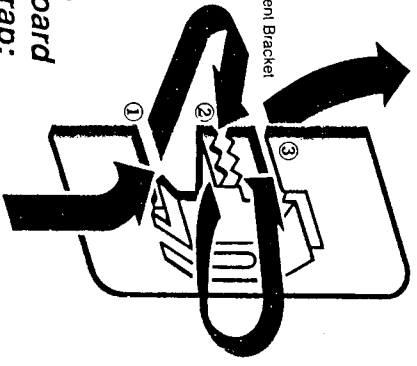

Cut-away
Hoop Adjustment Bracket

Step 2.

Backboard and Strap:

Start from the front. Weave Strap through Slot #1, back through teeth of Slot #2 (squeeze clip to "open" teeth, if necessary), then through Slot #3 as shown. Pull through enough strap to reach to top of door. From the back, thread full length through Slot #4.

Step 3. Strap and Door Clamps:

Start with Clamp for the TOP. Make sure Strap isn't twisted: start from the front, stick end through large square hole (#5) and weave back through Slot #6, then Slot #7 as shown. Pull through a tab about 6" long. Slide clamp onto top edge of door and let assembly hang. Assemble bottom clamp. To make entire assembly fit door snugly, pull down on free end of Strap and up on main section on top clamp.

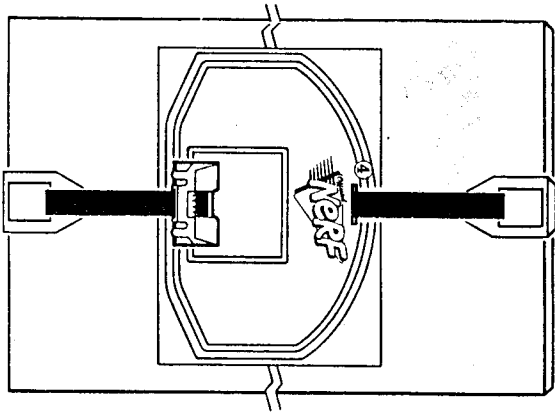
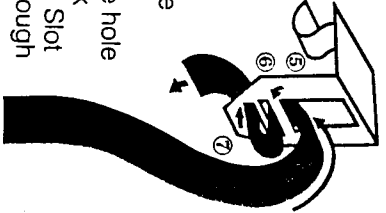

Step 4. Hoop and Net:

Hold Hoop with solid edge up and cored-out edge down. Determine which end of the Net has the longer loops. Wedge each longer upper loop around a clip. Tug each loop to secure it.

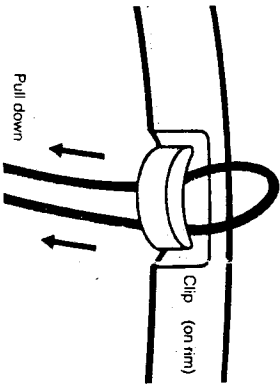

Step 5. Insert Hoop into Hoop Adjustment Bracket:

Hold Hoop vertically, parallel to door, as shown. Slide both L projections up and under "fingers" on Bracket. Push Hoop up until it "clicks".

This hoop is designed for safety and will pull out if excessive strain is placed on the rim. If this happens, just snap it back in by pushing the hoop's L projections back into the Bracket.

Your PRO HOOP game is now fully assembled. To play, grasp the hoop right near the bracket and flip it up until it "clicks" into place; store it with the rim flipped down, out of the way. Do not flip the hoop up and down by grabbing the outer part of the rim.

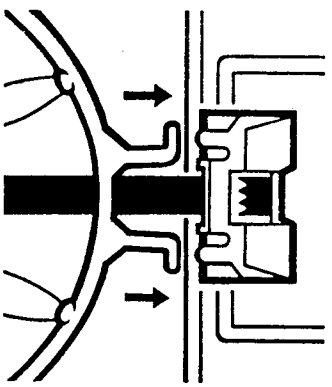

To Adjust the Height:

Hold Strap firmly and squeeze center section of Hoop Adjustment Bracket to open teeth. Slide entire Backboard unit up or down Strap to desired height.

Do not adjust height by pulling on the hoop.
* If you want to permanently install the hoop, the bracket is pre-drilled with two screw holes.

We will be happy to hear your questions or comments about this game. Write to: Consumer Relations, Parker Brothers, P.O. Box 1012, Beverly, MA 01915.

