

Perfect for indoor or outdoor fun!

Keep the fun in high gear - in either mode!

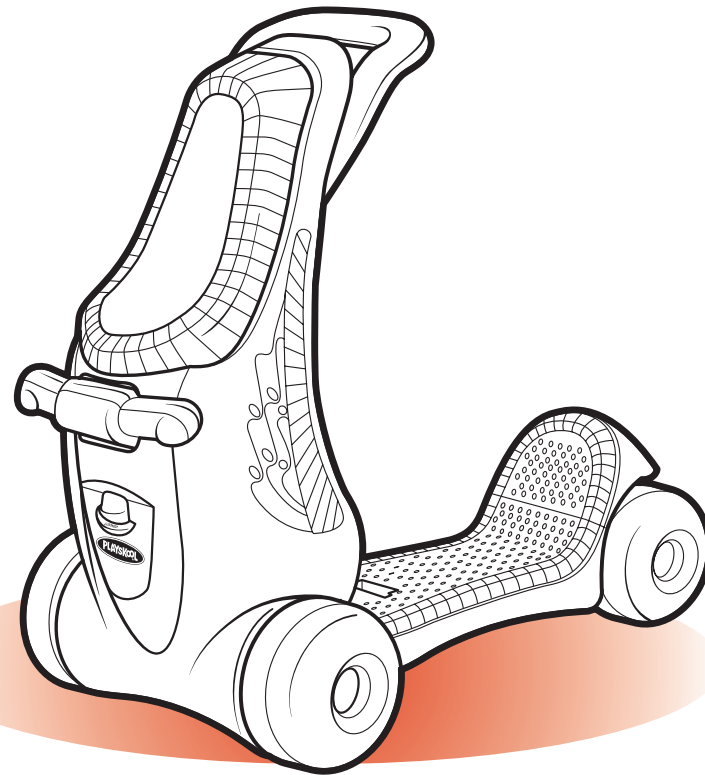

Easy-grip handlebars!

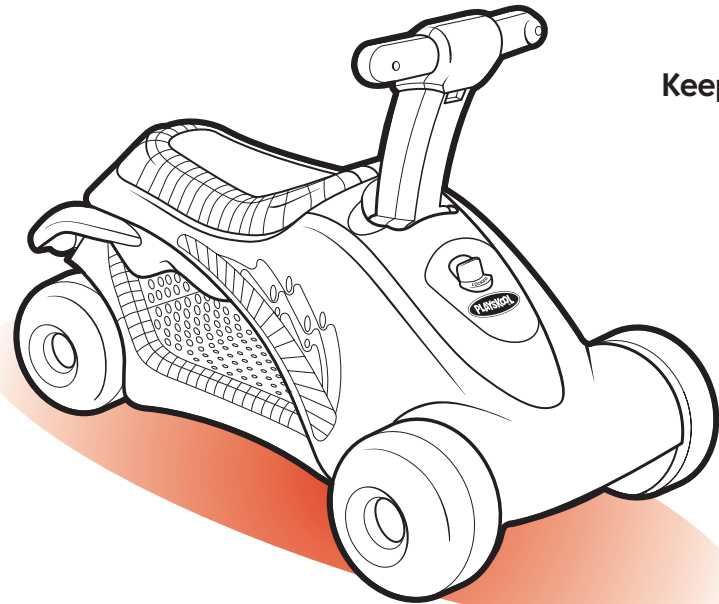
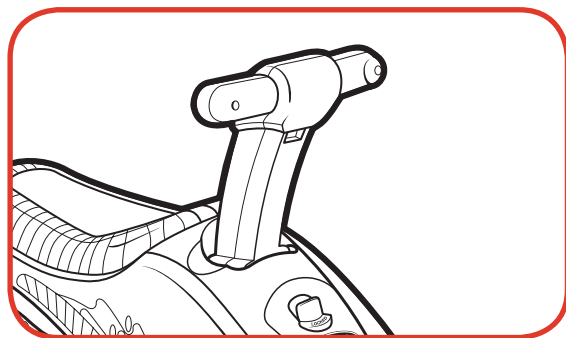

PLAYSKOOL

Ride2Roll™ Scooter

Thank you for buying this **PLAYSKOOL** brand product!

Parts include:

1 base, 1 end piece, 1 vehicle body, 4 wheels, 1 axle, 1 handlebar section, 1 top handle, 2 labels, 1 bag of screws.

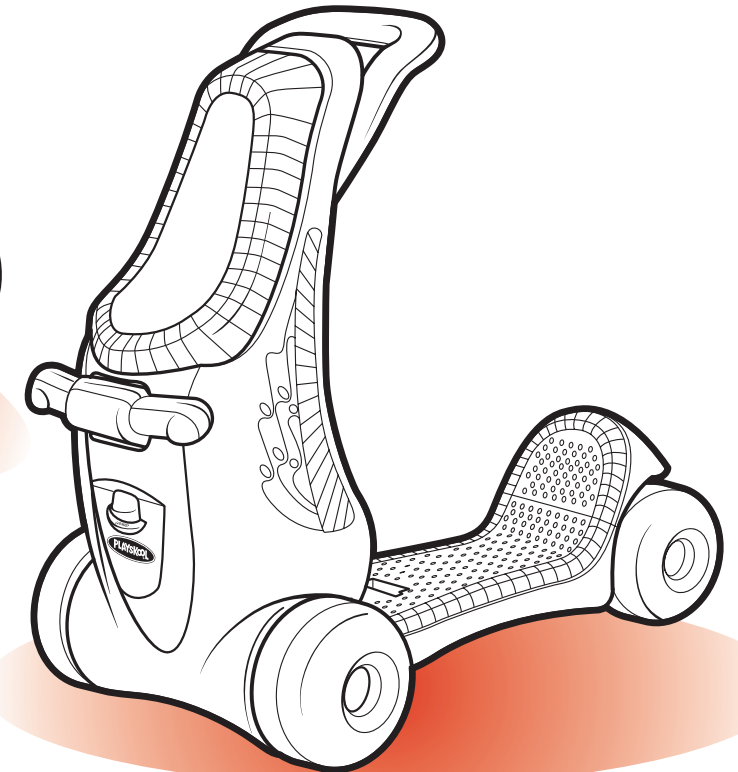
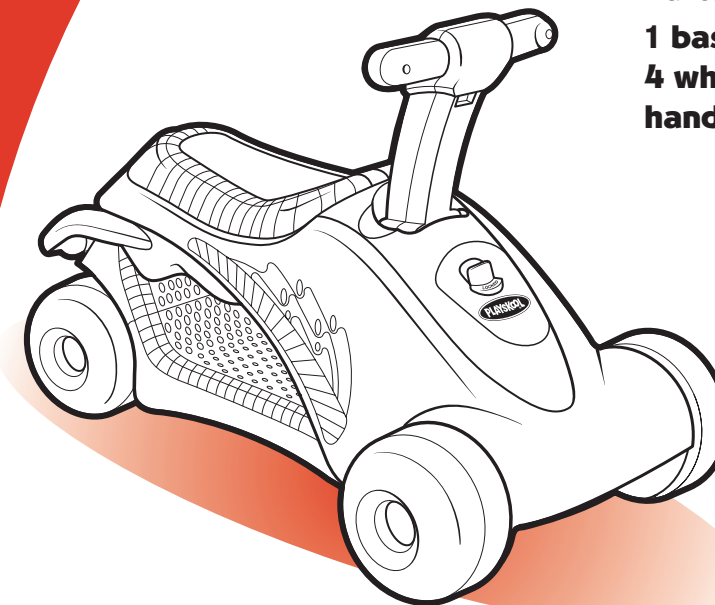

Adult assembly required.

**MAXIMUM WEIGHT
60 LBS. (27.2 KGS.)**

CAUTION: This product contains small parts which are necessary for assembly. Prior to and during assembly of this product, keep small parts out of children's reach. Small parts pose a choking hazard to children under 3 years.

WARNING: TO AVOID SERIOUS INJURY: Continuous adult supervision required; never use motor vehicles, near streets, swimming pools, hills, steps or sloped driveways. Always wear shoes. Allow only one rider.

WARNING: Always wear protective equipment including helmet, wrist guards, knee pads and elbow pads (not included). Close-toed shoes or sneakers must be worn.



ASSEMBLY

1. Attach End piece to Base

Fit end piece onto base. From underside of base, tighten 2 screws into base and end piece.

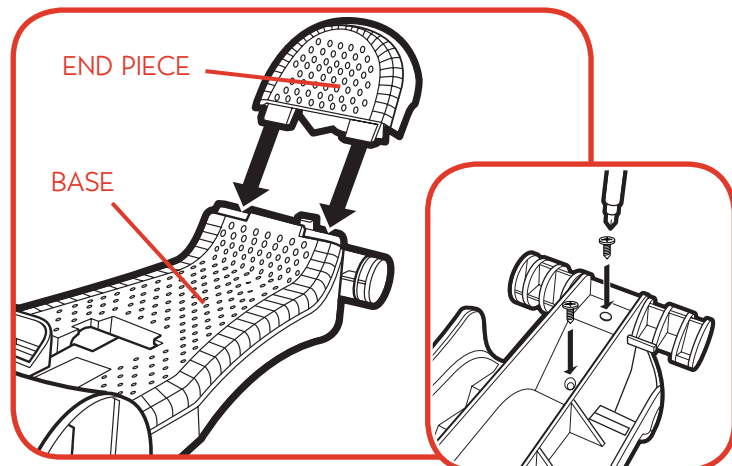

2. Attach Top Handle to Vehicle Body

Fit top handle onto vehicle body (align 3 tabs on holder with slots on body). Tighten 6 screws into top handle and vehicle body.

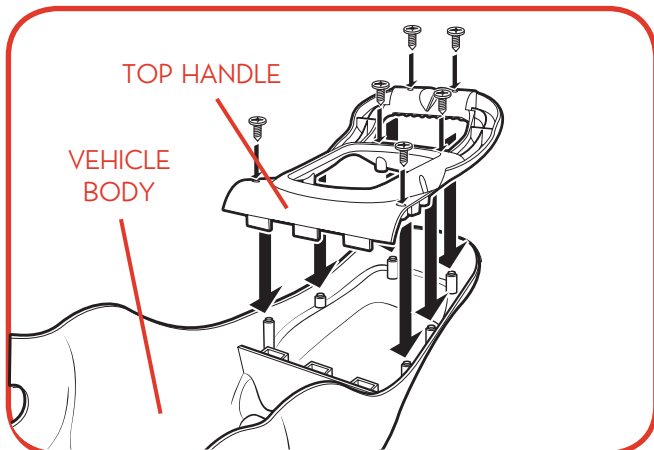

5. Attach Handlebar Section

Press latch on vehicle body, slide arm of handlebar section through hole in vehicle body, and snap handlebar arm into post on base.

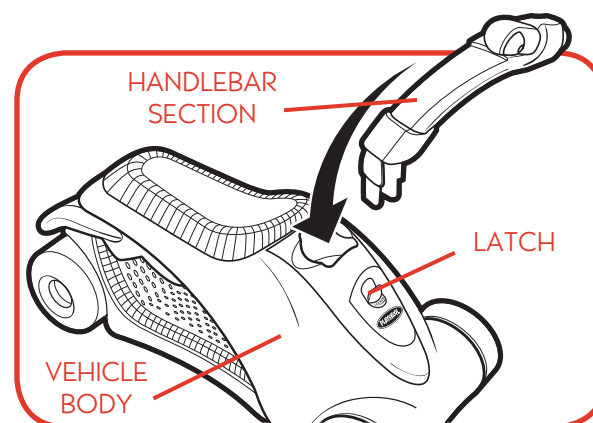

Tighten screw into base post and handlebar arm.

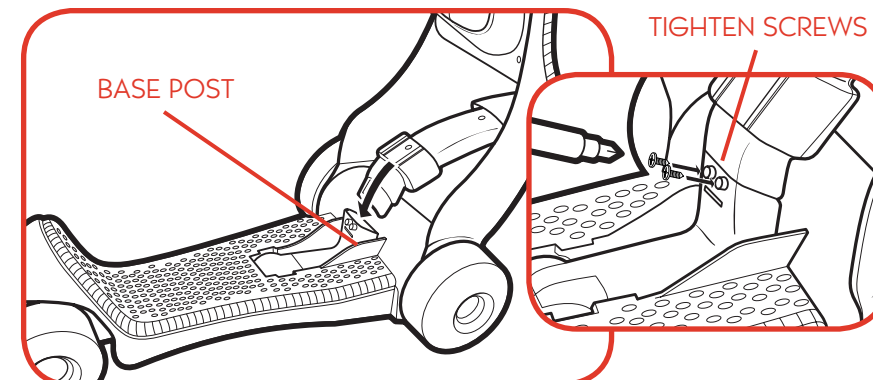

3. Attach Vehicle Body and Axle to Base

Fit vehicle body onto base (align holes in body with holes in base). Insert axle through holes. From underside of vehicle, tighten screw into axle and base.

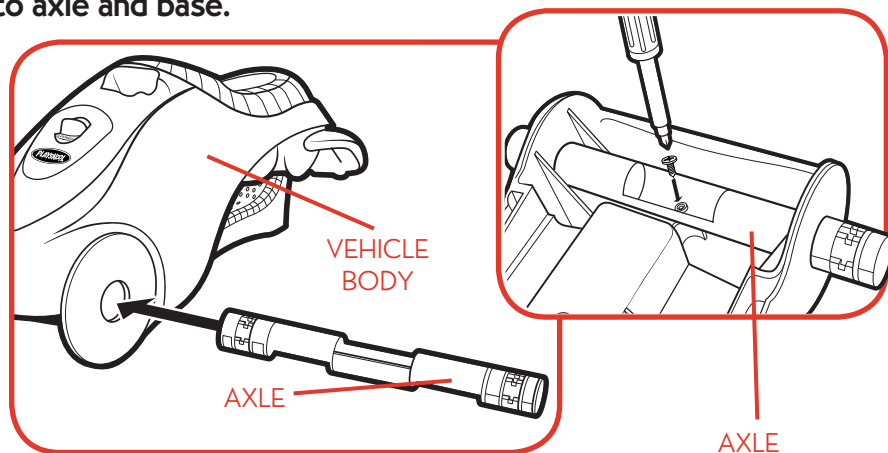
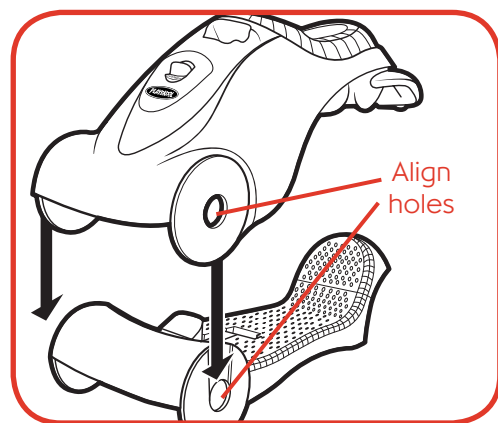

6. Attach Labels

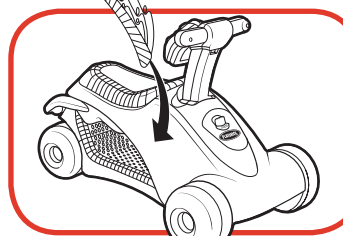

NOW YOU'RE READY TO ROLL OR RIDE...YOU DECIDE!

This unique toddler toy offers 2 kinds of vehicle play!
Use it as a ride-on or scooter!

4. Attach Wheels to Vehicle

Note: Be sure rounded side of wheels face out when attaching to vehicle. Snap smaller wheels onto rear of base. Snap larger wheels onto axle.

1. Place the RIDE2ROLL™ Scooter on the floor. Position scooter on its side.

2. Snap each wheel firmly into place as shown. You will hear a "click" once each wheel is properly connected. This is a one-time assembly.

3. Once the wheels are snapped into place, test each wheel by hand to make sure that it rotates freely.

NOTE: If you have followed these steps and the wheels do not rotate freely repeat steps 2 and 3 and apply more pressure to the wheels.

If wheels still do not spin freely after proper assembly, call I-800-PLAYSKL.

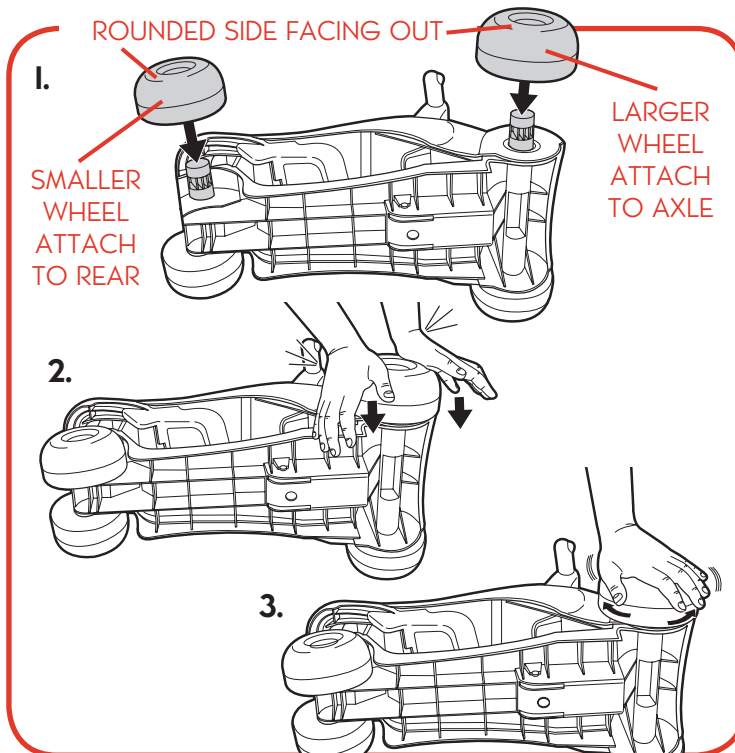

RIDE-ON

For growing toddlers, the RIDE2ROLL Scooter is a foot-to-floor ride-on that offers extra height and leg room.

If the toy is in scooter mode:

- Push latch on vehicle body downward and bring vehicle body down until it locks into place. Be sure the word "LOCKED" appears on latch.

Now you're ready to ride!

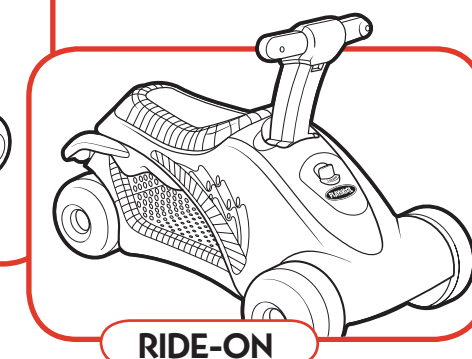
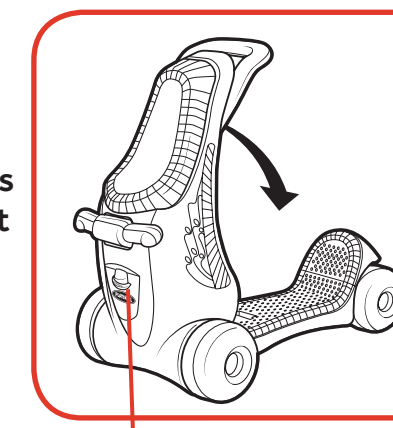

SCOOTER

As your child grows steadier on his feet, this toy easily converts to a child's first scooter that encourages balance, coordination and timing.

If the toy is in ride-on mode:

- Press latch on vehicle body and raise vehicle body until it locks into place. Be sure the word "LOCKED" appears on latch.

Now you're ready to roll!

