

TECHNO TOIDS™

ELECTRONIC PEGASUS™ EVIL PEGASUS™

IMPORTANT
Please read before instructions to ensure proper assembly and operation. Do not use any other parts.
2. The red and black wires on the Power Drive Unit are for the motor. Do not connect them to the battery.
3. Before you connect any part, make sure you have disconnected the battery from the kit. Do not connect the battery to the kit until you are ready to start the motor.
4. Do not touch the motor or the battery when the kit is connected to the battery. The battery is a 9V battery. Do not touch the battery when the kit is connected to the battery.
5. Do not touch the battery when the kit is connected to the battery. The battery is a 9V battery.

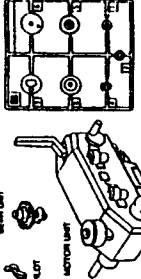

LABELS	
1	PILOT
2	MOTOR UNIT
3	BATTERY
4	HEAD
5	NECK
6	THORAX
7	WINGS
8	TAIL
9	LEFT LASER GUN
10	RIGHT LASER GUN
11	LEFT WING
12	RIGHT WING
13	LEFT TAIL
14	RIGHT TAIL
15	LEFT LEG
16	RIGHT LEG
17	LEFT FOOT
18	RIGHT FOOT
19	LEFT ARM
20	RIGHT ARM
21	LEFT HAND
22	RIGHT HAND
23	LEFT ELBOW
24	RIGHT ELBOW
25	LEFT SHOULDER
26	RIGHT SHOULDER
27	LEFT CLAVICLE
28	RIGHT CLAVICLE
29	LEFT RIB
30	RIGHT RIB
31	LEFT STERNUM
32	RIGHT STERNUM
33	LEFT PELVIS
34	RIGHT PELVIS
35	LEFT HIP
36	RIGHT HIP
37	LEFT THIGH
38	RIGHT THIGH
39	LEFT KNEE
40	RIGHT KNEE
41	LEFT SHIN
42	RIGHT SHIN
43	LEFT ANKLE
44	RIGHT ANKLE
45	LEFT FOOT
46	RIGHT FOOT
47	LEFT TOE
48	RIGHT TOE
49	LEFT HEEL
50	RIGHT HEEL

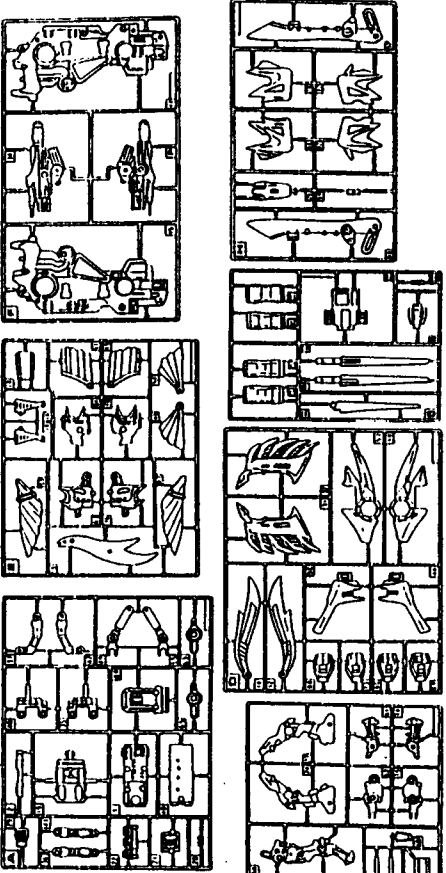

① ASSEMBLY OF THE POWER DRIVE UNIT

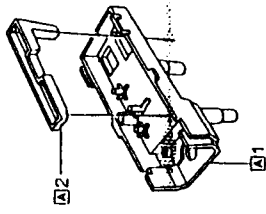

②

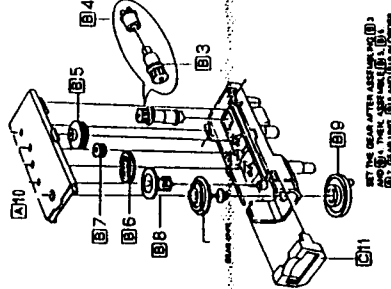

③ ASSEMBLY OF THE BODY

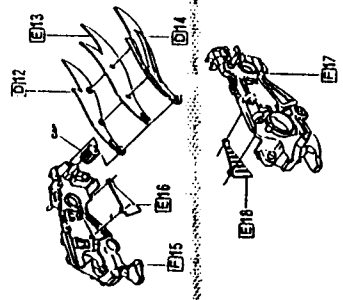

④

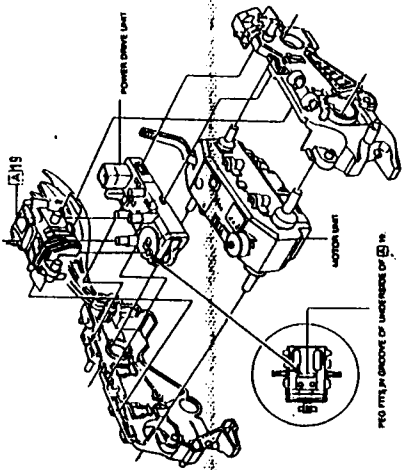

⑤

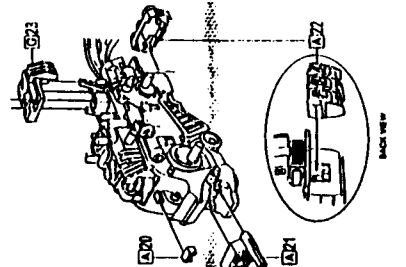

⑥ ASSEMBLY OF THE HEAD



⑦

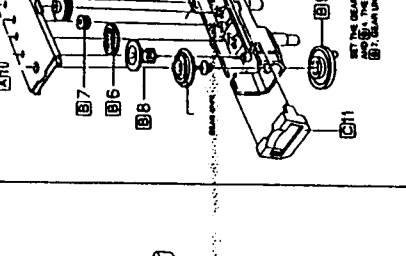

⑧

⑨ ASSEMBLY OF THE LEFT LASER GUN

⑩ ASSEMBLY OF THE RIGHT LASER GUN

⑪

⑫ ASSEMBLY OF THE LEFT WING

⑬

