

# MONOPOLY



FOR 2-4 PLAYERS AGES 8+  
ADULT ASSEMBLY REQUIRED

## STARTUP GUIDE

**Contents:** Electronic Tower, Gameboard, 4 Game Pieces, 4 Bank Cards, Card Slot Piece, Cab with Track, Title Deed Cards, 32 Houses, 12 Hotels, 2 "Green" Pieces.  
Remove the wrappings from the game parts, then discard or recycle the wrappings.

### ASSEMBLING YOUR GAME

It's easy! Just follow the two steps below. As you assemble your game, refer to the game setup photo at right.

**IMPORTANT:** Before assembling your game, insert four AA-size batteries into the tower as described under BATTERY INFORMATION on the other side of this sheet.

- 1 Fit the tower into the center of the slot piece, then lower the gameboard over the tower. **Note: The gameboard fits only one way over the tower.**



Line up the power button with the car image on the gameboard.

- 2 Attach the track and cab to the gameboard.



Fit track halves together, then press flat onto board.

Slide track tabs into gameboard holes.

### WHAT'S DIFFERENT ABOUT MONOPOLY LIVE?

**MONOPOLY LIVE** has a talking, motion-sensing tower that guides you through the game. A special camera in the tower "sees" reflective material on the game pieces, bank cards, cab, and YES/NO icons.

You won't need to read any rules to play this game, but you can check them out anytime at [www.monopoly.com](http://www.monopoly.com)

### SET UP, POWER UP & PLAY!

When assembled and set up, your game will look as shown below. Now just press the power button on the tower, and you're ready to play! See Tower Controls below.



### TOWER CONTROLS

**VOLUME DIAL:** Turn to increase or decrease volume.

**POWER/PAUSE BUTTON:** Press to turn the game on. Press to pause and unpause game. Press and hold to end the current game. Press and hold longer to power down.

**AUTO SHUTOFF:** THE GAME WILL AUTOMATICALLY SHUT OFF IF THERE IS NO ACTIVITY FOR ABOUT FIVE MINUTES.



### GAMEPLAY BASICS

Here's all you need to know to communicate with the tower, manage your cash and take the cab for a ride.

#### ROLLING THE DICE

Cover your game piece to roll the dice.



#### CONFIRMING & REPEATING

Cover YES or NO to confirm something. Cover BOTH to hear something repeated.



#### USING YOUR BANK CARD

Insert your card into the slot to check your balance anytime, trade properties, build houses, or raise cash.



#### TAKING THE CAB

When the tower tells you to catch the cab, give it a push, and see where it lands!



### BATTERY INFORMATION

**x4 ALKALINE BATTERIES REQUIRED**  
1.5V AA or LR6 Size  
NOT INCLUDED  
Phillips/cross head screwdriver (not included) needed to insert batteries.

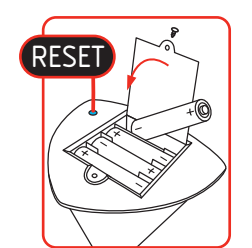

#### INSERTING THE BATTERIES

Make sure the tower is OFF. Loosen the screw on the battery compartment, located on the underside of the tower, and remove the door. Insert 4 AA-size alkaline batteries, making sure to align the + and - symbols with the markings in the plastic. Then replace the door, tighten the screw, and push in RESET.

## CAUTION:

1. Always follow the instructions carefully. Use only batteries specified and be sure to insert item correctly by matching the + and - polarity markings.
2. Do not mix old batteries and new batteries or standard (carbon-zinc) with alkaline batteries.
3. Remove exhausted or dead batteries from the product.
4. Remove batteries if product is not to be played with for a long time.
5. Do not short-circuit the supply terminals.
6. Should this product cause, or be affected by, local electrical interference, move it away from other electrical equipment. Reset (switching off and back on again or removing and re-inserting batteries) if necessary.
7. RECHARGEABLE BATTERIES: Do not mix these with any other types of batteries. Always remove from the product before recharging. Recharge batteries under adult supervision. DO NOT RECHARGE OTHER TYPES OF BATTERIES.

#### FCC Statement

This equipment has been tested and found to comply with the limits for a Class B digital device, pursuant to part 15 of the FCC Rules. These limits are designed to provide reasonable protection against harmful interference in a residential installation. This equipment generates, uses, and can radiate radio frequency energy, and, if not installed and used in accordance with the instructions, may cause harmful interference to radio communications. However, there is no guarantee that interference will not occur in a particular installation. If this equipment does cause harmful interference to radio or television reception, which can be determined by turning the equipment off and on, the user is encouraged to try to correct the interference by one or more of the following measures:

- Reorient or relocate the receiving antenna.
- Increase the separation between the equipment and receiver.
- Consult the dealer or an experienced radio/TV technician for help.

**CAUTION:** Changes or modifications not expressly approved by the party responsible for compliance could void the user's authority to operate the equipment.

This Class B digital apparatus complies with Canadian ICES-003.

Cet appareil numérique de la classe B est conforme à la norme NMB-003 du Canada.

#### NOTE TO UK Consumers:

This product and its batteries must be disposed of separately at your local waste recycling centre. Do not dispose of in your household waste bin.

© 1935, 2011 Hasbro. All rights reserved.

Manufactured by: Hasbro Inc, Pawtucket, RI 02862 USA  
Hasbro Europe, 2 Roundwood Ave, Stockley Park, Uxbridge, Middlesex, UB11 1AZ, UK. Hasbro Europe is the authorised representative of Hasbro SA in the European Union. Hasbro Australia Ltd., Level 2, 37-41 Oxford Street, Epping NSW 2121, Australia. Tel: 1300 138 697. Hasbro NZ (a branch of Hasbro Australia Ltd.), 221 Albany Highway, Auckland, New Zealand. Tel: 0508 828 200.

HASBRO CANADA, LONGUEUIL, QC, CANADA J4G 1G2  
Consumer contact: USA and Canada: Hasbro Games, Consumer Affairs Dept., P.O. Box 200, Pawtucket, RI 02862 USA. Tel: 888-836-7025.

UK: Consumer Services: Hasbro UK Ltd., PO Box 43 Newport NP19 4YD, UK. Tel: 0800 094 9797. Consumer affairs@hasbro.co.uk www.hasbro.co.uk Hasbro Australia Ltd., Level 2, 37-41 Oxford Street, Epping NSW 2121, Australia. Tel: 1300 138 697. Hasbro NZ (a branch of Hasbro Australia Ltd.), 221 Albany Highway, Auckland, New Zealand. Tel: 0508 828 200.

The HASBRO and MONOPOLY names and logos, the distinctive design of the gameboard, the four corner squares, as well as each of the distinctive elements of the board and playing pieces are trademarks of Hasbro for its property trading game and game equipment. ©1935, 2011 Hasbro, Pawtucket RI 02862. All Rights Reserved. TM & © denote U.S. Trademarks. U.S. Pat. Nos. 5521616, 5288078 and Patent Pending.

19652



[monopoly.com](http://monopoly.com)

#### PROOF OF PURCHASE



19652



10K1108-4\_19652i000\_Side A



10K1108-4\_19652i000\_Side B